



STEN
steel is our business

HAROTERASE

Tootekataloog

SISUKORD

KANGTERASED

lk 1

Ümar
Armatuur
Nelikanterras
Kuuskanterras
Kiiluteras
Paksuseinalised torud
Nurk
Latt
Profiilid

TORUD

lk 15

Instrumenditorud
Venitatud torud
Protsessorud
Harjatud torud
Kapillaartorud
Meiereitorud
Lihvitud torud
Käsipuu tarvikud
Profiilitorud

LEHED

lk 23

TORUTARVIKUD

lk 25

Meierei tarvikud
Põlved
Üleminekud
Kolmikud
Lõpud ja kandjad
Pressitud vabaäärrik
Pressitud kaelusäärrik
Pressitud kaelused
Tihendid

SILUMIIN VABA- JA KUUMTSINGITUD

TERASÄÄRIKUD

lk 33

TREITUD ÄÄRIKUD

J A K A E L U S E D

lk 34

Treitud kaelused
Vabaäärrikud
Pimeäärrikud
Kaelusäärrikud
Keevitatud äärikud

VENTIILID JA

MUDAERALDAJAD

lk 41

Kuulventiil
Mudaeraldaja
Nõelventiil
Tagasilöögi ventiil

PRESSLIITMIKUD

lk 43

Presspõlved
Muhvid
Korgid
Liitmikud
Ühendused
Kolmikud
Kuulventiilid
Üleminekud
Presstorud

SURVELIITMIKUD

lk 53

Lõppliide
Jätkuliide
Nurkliide
Kolmikliide
Mutrid ja löikerõngad

KEERMESTATUD TORULIITMIKUD

lk 56

Muhvid, niplid
Kübarad, korgid
Lukustusmutrid
Nurkühendused
Koonusliitmikud
Üleminekuniplid ja -muhvid
Torukaared
Küüs- ja nookurliitmikud
Voolikuotsad
Voolikupingutaja

VÖRDLUS- JA

ANALÜÜSITABELID

lk 65

PERFOLEHED

lk 66

KANGTERASED

ÜMAR



Tolerantsid: h9
Pikkus: 3000-6000 mm
Vastavustunnistus:
EN 10204/3.1

VENITATUD, KALIBREERITUD

Mööd Ø mm	Kaal kg/m	EN 1.4301 AISI 304	EN 1.4404 AISI 316L	Mööd Ø mm	Kaal kg/m	EN 1.4301 AISI 304	EN 1.4404 AISI 316L
3	0,05			28	4,83		
4	0,10			30	5,55		
5	0,15			32	6,31		
6	0,22			35	7,55		
7	0,30			36	7,99		
8	0,39			38	8,90		
10	0,62			40	9,86		
12	0,89			45	12,48		
14	1,21			50	15,41		
15	1,39			55	18,65		
16	1,58			60	22,20		
18	2,00			65	26,05		
20	2,47			70	30,21		
22	2,98			75	34,68		
24	3,55			80	39,40		
25	3,85			90	49,94		
26	4,17			100	61,65		

LIHVITUD

Tolerantsid: h9
Pikkus: 4000-6000 mm
Vastavustunnistus:
EN 10204/3.1

Mööd Ø mm	Kaal kg/m	EN 1.4460 AISI 329	Mööd Ø mm	Kaal kg/m	EN 1.4460 AISI 329
15	1,38		40	9,87	
16	1,58		45	12,49	
20	2,47		50	15,41	
25	3,85		55	18,65	
30	5,55		60	22,20	
35	7,55		70	30,21	



Pikkus: 4000-6000 mm

Vastavustunnistus:
EN 10204/3.1

LÖÖMUTATUD, TREITUD

Mõõt Ø mm	Kaal kg/m	EN 1.4301 AISI 304	EN 1.4404 AISI 316L
24	3,55		
25	3,85		
26	4,17		
28	4,83		
30	5,55		
32	6,31		
35	7,55		
36	7,99		
38	8,90		
40	9,87		
45	12,49		
50	15,41		
55	18,65		
60	22,20		
65	26,05		
70	30,21		
75*	34,68		
80*	39,46		
85*	44,55		
90*	49,94		
95*	55,64		
100*	61,65		
110*	74,60		
120*	88,80		

Mõõt Ø mm	Kaal kg/m	EN 1.4301 AISI 304	EN 1.4404 AISI 316L
125*	96,33		
130*	104,20		
135*	112,40		
140*	120,80		
150*	138,70		
160*	157,80		
170	178,20		
180	199,80		
190	222,6		
200	246,60		
210	271,90		
220	298,40		
225	312,10		
230	326,20		
240	355,10		
250	385,30		
260	416,80		
280	483,40		
285	500,80		
300	554,90		
325	651,20		
350	755,30		
375	867,00		
400	986,50		

* Samuti AISI 303 /
EN 1.4305

VENITATUD

Tolerantsid: h9

Pikkus: 3000-6000 mm

Vastavustunnistus:
EN 10204/3.1

Mõõt Ø mm	Kaal kg/m	EN 1.4462 AISI 329
12	0,89	
14	1,21	
16	1,58	
18	2,00	

Mõõt Ø mm	Kaal kg/m	EN 1.4462 AISI 329
20	2,47	
25	3,85	
70	30,21	



Pikkus: 4000-6000 mm

Vastavustunnistus:
EN 10204/3.1

LÕÖMUTATUD, TREITUD

Mööd Ø mm	Kaal kg/m	EN 1.4460 AISI 329
20,0	2,47	
22,0	2,98	
25,4	3,85	
28,6	5,10	
31,0	5,93	
33,0	6,71	
36,0	7,99	
41,0	10,36	
46,0	13,05	
51,2	16,25	
56,2	19,60	
61,2	23,10	
66,2	27,10	
71,4	31,40	
76,4	36,00	
81,4	40,90	
85,0	44,55	

Mööd Ø mm	Kaal kg/m	EN 1.4460 AISI 329
91,4	52,46	
96,4	58,36	
102	64,11	
107	70,55	
112	77,30	
117	84,36	
122	91,72	
127	99,40	
132	107,43	
143	124,30	
150	138,70	
153	144,00	
163	164,00	
173	185,00	
184	209,00	
204	257,00	
212	277,10	
230	326,20	

Tolerantsid: k11-k12

Pikkus: 3000-6000 mm

Vastavustunnistus:
EN 10204/3.1

TREITUD

Mööd Ø mm	Kaal kg/m	EN 1.4462
20	2,47	
30	5,55	
35	7,55	
40	9,87	
45	12,49	
50	15,41	
55	18,65	
60	22,20	
70	30,21	
75	34,68	

Mööd Ø mm	Kaal kg/m	EN 1.4462
80	39,46	
90	49,94	
100	61,65	
105	67,97	
120	88,80	
130	104,20	
140	120,80	
150	138,70	
160	157,80	
170	178,20	
200	246,60	



Tolerantsid: h8 / h9/ h11

Pikkus: 3000 mm

Vastavustunnistus:
EN 10204/3.1

VENITATUD/TREITUD, LIHVITUD

Mööd Ø mm	Kaal kg/m h8	EN 1.4305 AISI 303	EN 1.4305 AISI 303 h9
3	0,05		
4	0,10		
5	0,15		
6	0,22		
7	0,30		
8	0,39		
10	0,62		
12	0,89		
14	1,21		
15	1,39		
16	1,58		
18	2,00		
20	2,47		
22	2,98		

Mööd Ø mm	Kaal kg/m h9	EN 1.4305 AISI 303	EN 1.4305 AISI 303 h11
25	3,85		
26	4,17		
28	4,83		
30	5,55		
32	6,31		
35	7,55		
36	7,99		
38	8,90		
40	9,86		
42	10,88		
45	12,48		
50	15,41		
55	18,65		
60	22,20		
65	26,05		
70	30,21		
75	34,68		
80	39,40		
85	44,55		
90	49,94		
100	61,65		

VENITATUD

Tolerantsid: h9

Pikkus: 3000-6000 mm

Vastavustunnistus:
EN 10204/3.1

Mööd Ø mm	Kaal kg/m	EN 1.4301 AISI 304	EN 1.4404 AISI 316L
3,50	0,08		
4,40	0,12		
5,30	0,17		
7,10	0,31		

Mööd Ø mm	Kaal kg/m	EN 1.4301 AISI 304	EN 1.4404 AISI 316L
8,93	0,49		
10,76	0,71		
14,60	1,31		
18,20	2,03		
21,90	2,94		

ÜMAR



Valtsitud,
tugevus max. 223 HB.

Vastavustunnistus:
EN 10204/3.1

TULEKINDEL

Mööd Ø mm	Kaal kg/m	EN 1.4828 X15CrNiSi20-12
20	2,47	
30	5,55	
40	9,87	
50	15,41	

Mööd Ø mm	Kaal kg/m	EN 1.4828 X15CrNiSi20-12
60	22,20	
70	30,21	
80	39,46	
90	49,94	
100	61,65	

ARMATUUR



Pikkus: 6000 mm

Mööd Ø mm	Kaal kg/m	EN 1.4301 AISI 304
5	0,15	
7	0,30	
9	0,50	
11	0,75	

NELIKANTTERAS



Pikkus: 4000-6000 mm

Vastavustunnistus:
EN 10204/3.1

LÕÕMUTATUD, PEITSITUD



+ venitatud,
tol. h11,
Pikkus 3000-
3200 mm

* + AISI 304

Mööd Ø mm	Kaal kg/m	EN 1.4404 AISI 316L
5	0,20	
8	0,51	
10	0,78	
12	1,13	
15	1,77	
20*	3,14	

Mööd Ø mm	Kaal kg/m	EN 1.4404 AISI 316L
25	4,91	
30*	7,01	
40*	12,56	
50*	19,63	
60*	28,27	
70	38,47	

KUUSKANTTERAS



Tolerantsid: h11

DIN 176

Pikkus: 3000-3200 mm

Vastavustunnistus:
EN 10204/3.1

VENITATUD

Mööd Ø mm	Kaal kg/m	EN 1.4305 AISI 303	EN 1.4404 AISI 316L
6	0,25		
8	0,435		
10	0,68		
11	0,82		
13	1,15		
14	1,33		
17	1,96		
19	2,45		
22	3,29		
24	3,92		

Mööd Ø mm	Kaal kg/m	EN 1.4305 AISI 303	EN 1.4404 AISI 316L
27	4,96		
30	6,12		
32	6,96		
36	8,81		
41	11,43		
46	14,39		
50	17,00		
55	20,57		
60	24,48		
65	28,72		

KIILUTERAS

Tolerantsid: DIN 6880

Pikkus: n. 3 m

Vastavustunnistus:
EN 10204/3.1

KÜLMVENITATUD

Mööd Ø mm	Kaal kg/m	EN 1.4571 AISI 316Ti
4 x 4	0,13	
5 x 5	0,20	
6 x 6	0,28	
8 x 7	0,44	
8 x 8	0,30	
10x6	0,47	
10x8	0,63	
12x8	0,75	

Mööd Ø mm	Kaal kg/m	EN 1.4571 AISI 316Ti
10 x 10	0,79	
14 x 9	0,99	
16 x 10	1,26	
18 x 11	1,55	
20 x 12	1,88	
25 x 14	2,75	
28 x 16	3,52	

PAKSUSEINALISED TORUD

Pikkus:
4000-7000 mm

Vastavustunnistus:
EN 10204/3.1

LÕÖMUTATUD, PEITSITUD



Mööd Ø mm	Kaal kg/m	EN 1.4306 AISI 304L	EN 1.4404 AISI 316L
32/16	5,1		
32/20	4,2		
36/16	6,8		
36/20	5,9		
36/25	4,5		
40/20	7,8		
40/25	6,5		
40/28	5,5		
45/20	10,5		
45/28	8,2		
45/32	6,7		
50/25	12,1		
50/32	9,7		
50/36	8,0		
56/28	15,2		
56/36	12,1		
56/40	10,2		
63/32	19,0		
63/36	17,3		
63/40	15,4		
63/45	12,2		
63/50	9,9		
71/36	24,1		
71/40	22,3		
71/45	19,6		
71/50	17,0		
71/56	12,9		

Mööd Ø mm	Kaal kg/m	EN 1.4306 AISI 304L	EN 1.4404 AISI 316L
75/40	26,0		
75/50	20,4		
75/60	13,8		
80/40	30,9		
80/45	28,3		
80/50	25,3		
80/63	16,4		
85/45	33,5		
85/55	27,4		
85/67	18,6		
90/50	36,1		
90/56	32,3		
90/63	27,1		
90/71	20,6		
95/50	42,1		
95/67	30,0		
100/56	42,3		
100/63	39,2		
100/71	32,7		
100/80	24,4		
106/56	52,1		
106/63	47,1		
106/71	40,6		
106/80	32,3		
112/63	55,3		
112/71	48,8		

JÄRG →

PAKSUSEINALISED TORUD

Mõõt Ø mm		EN 1.4306 EN 1.4404	
		AISI 304L	AISI 316L
112/80	40,6		
112/90	30,3		
118/63	64,2		
118/71	57,6		
118/80	49,4		
118/90	39,0		
125/71	68,5		
125/80	60,2		
125/90	49,8		
125/100	38,3		
132/71	79,7		
132/80	71,5		
132/90	61,1		
132/106	42,0		
140/80	85,2		
140/90	74,9		
140/100	63,3		
140/112	47,8		
150/80	103,3		
150/95	87,7		
150/106	74,2		
150/125	47,4		
160/90	112,9		
160/112	85,8		
160/122	71,6		
160/132	56,2		

Mõõt Ø mm	Kaal kg/m	EN 1.4306 EN 1.4404	
		AISI 304L	AISI 316L
170/100	122,3		
170/118	98,4		
170/130	80,2		
170/140	63,8		
180/100	144,7		
180/125	110,0		
180/140	86,1		
180/150	68,4		
190/132	123,0		
190/150	91,9		
190/160	73,0		
200/140	134,0		
200/150	117,0		
200/160	97,6		
212/130	182,0		
212/170	109,0		
224/140	199,0		
224/180	121,0		
236/150	216,0		
236/190	133,0		
250/200	153,0		

NURK



Pikkus: 6000 mm

Vastavustunnistus:
EN 10204/3.1

LÕÕMUTATUD, PEITSITUD

Mõõt Ø mm	Kaal kg/m	EN 1.4301 AISI 304	EN 1.4404 AISI 316L
20 x 20 x 3	0,88		
25 x 25 x 3	1,12		
30 x 30 x 3	1,36		
30 x 30 x 4	1,78		
40 x 40 x 4	2,42		
50 x 50 x 5	3,77		
60 x 60 x 6	5,42		
70 x 70 x 7	7,38		
80 x 80 x 8	9,66		
100 x 100 x 10	15,10		
150 x 150 x 10	23,20		
150 x 150 x 13	29,85		

ERIMÕÕTU NURK



Mõõt Ø mm	Kaal kg/m	EN 1.4301 AISI 304	EN 1.4404 AISI 316L
50 x 30 x 5	3,04		
60 x 30 x 5	3,45		
60 x 40 x 6	4,52		
70 x 50 x 6	5,48		
80 x 40 x 6	5,48		
100 x 50 x 6	6,92		
120 x 80 x 8	12,29		
130 x 65 x 8	11,97		
150 x 100 x 10	19,20		

LATT



Pikkus:
4000-6000 mm

Vastavustunnistus:
EN 10204/3.1

LÕIGATUD, LÕÖMUTATUD JA PEITSITUD

Mõõt Ø mm	Kaal kg/m	EN 1.4301 AISI 304	EN 1.4404 AISI 316L	Mõõt Ø mm	Kaal kg/m	EN 1.4301 AISI 304	EN 1.4404 AISI 316L
3 x 20	0,47			6 x 70	3,30		
3 x 25	0,58			6 x 80	3,77		
3 x 30	0,70			6 x 100	4,71		
3 x 40	0,94			8 x 20	1,26		
3 x 50	1,18			8 x 30	1,88		
4 x 20	0,62			8 x 40	2,51		
4 x 25	0,78			8 x 50	3,14		
4 x 30	0,94			8 x 60	3,77		
4 x 40	1,26			8 x 80	5,02		
4 x 50	1,57			8 x 100	6,28		
4 x 60	1,88			10 x 30	2,36		
4 x 80	2,51			10 x 40	3,14		
5 x 20	0,78			10 x 50	3,93		
5 x 25	0,98			10 x 60	4,71		
5 x 30	1,18			10 x 70	5,50		
5 x 40	1,57			10 x 80	6,28		
5 x 50	1,96			10 x 100	7,85		
5 x 60	2,36			10 x 120	9,42		
5 x 70	2,75			10 x 150	11,78		
5 x 80	3,14			12 x 40	3,77		
5 x 100	3,93			12 x 50	4,71		
6 x 20	0,942			12 x 60	5,65		
6 x 25	1,18			12 x 80	7,54		
6 x 30	1,41			12 x 100	9,42		
6 x 40	1,88			12 x 120	11,30		
6 x 50	2,36			12 x 150	14,13		
6 x 60	2,83						

 + venitatud, tol. h11

LATT



Pikkus:
4000-6000 mm
Vastavustunnistus:
EN 10204/3.1

KUUMVALTSITUD, LÕÖMUTATUD JA PEITSITUD

Mõõt Ø mm	Kaal kg/m	EN 1.4301 AISI 304	EN 1.4404 AISI 316L
6 x 20	0,94		
8 x 20	1,26		
10 x 20	1,57		
10 x 25	1,96		
10 x 30	2,36		
10 x 40	3,14		
10 x 50	3,93		
10 x 60	4,71		
10 x 80	6,26		
10 x 100	7,85		
12 x 20	1,88		
12 x 25	2,36		
12 x 30	2,83		
15 x 25	2,94		
15 x 30	3,53		
15 x 40	4,71		
15 x 50	5,89		
15 x 60	7,07		
15 x 80	9,42		
15 x 100	11,78		
20 x 30	4,71		
20 x 40	6,28		
20 x 50	7,85		
20 x 60	9,42		

Mõõt Ø mm	Kaal kg/m	EN 1.4301 AISI 304	EN 1.4404 AISI 316L
20 x 70	10,99		
20 x 80	12,56		
20 x 100	15,70		
25 x 30	5,89		
25 x 40	7,85		
25 x 50	9,81		
25 x 60	11,78		
25 x 70	13,74		
25 x 80	15,70		
25 x 100	19,63		
30 x 40	9,42		
30 x 50	11,78		
30 x 60	14,10		
30 x 70	16,49		
30 x 80	18,84		
30 x 100	23,55		
35 x 70	19,23		
35 x 80	21,98		
40 x 50	15,70		
40 x 60	18,80		
40 x 80	25,12		
40 x 100	31,40		
50 x 80	31,40		
50 x 100	39,26		
60 x 100	47,10		

UNP-PROFIIL

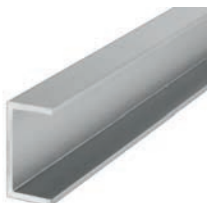

Mõõt mm	Kaal kg/m	EN 1.4301 AISI 304	EN 1.4404 AISI 316L
40 x 20 x 4 x 4,5	2,43		
40 x 35 x 5 x 7	4,98		
65 x 42 x 5,5 x 7,5	7,11		
80 x 45 x 6 x 8	8,68		
100 x 50 x 6 x 8,5	10,61		
120 x 55 x 7 x 9	13,40		
140 x 60 x 7 x 10	16,08		
160 x 65 x 7,5 x 10,5	18,96		

UAP-PROFIIL



Mõõt mm	Kaal kg/m	EN 1.4301 AISI 304	EN 1.4404 AISI 316L
80 x 40 x 5 x 5	6,00		
100 x 50 x 5 x 5	7,60		
100 x 50 x 6 x 6	9,00		

T-PROFIIL



Mõõt mm	Kaal kg/m	EN 1.4301 AISI 304	EN 1.4404 AISI 316L
30 x 30 x 3	1,38		
40 x 40 x 4	2,45		
50 x 50 x 5	3,81		
60 x 60 x 6	5,49		
80 x 80 x 8	9,74		
100 x 100 x 10	15,21		

HEB-TALA

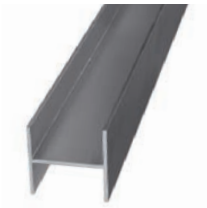

Mõõt mm	Kaal kg/m	EN 1.4301 AISI 304	EN 1.4404 AISI 316L
100 x 100 x 6 x 10	19,90		
120 x 120 x 6,5 x 11	26,20		
140 x 140 x 7 x 12	33,40		
160 x 160 x 8 x 13	41,90		

IPE-TALA



Mõõt mm	Kaal kg/m	EN 1.4301 AISI 304	EN 1.4404 AISI 316L
80 x 46 x 3,8 x 5,2	6,00		
100 x 55 x 4,1 x 5,7	7,90		
120 x 64 x 4,4 x 6,3	10,30		
140 x 73 x 4,7 x 6,9	12,80		
200 x 100 x 5,6 x 8,5	21,80		
300 x 150 x 7,1 x 10,7	41,50		





TORUD

INSTRUMENTIDORU



EN 10217-7 TC1

EN ISO 1127

Tolerantsid: D3/T3

Pikkus: 6000 mm

Vastavustunnistus:
EN 10204/3.1

Mööd Ø mm	Kaal kg/m	EN 1.4301 AISI 304	EN 1.4404 AISI 316L
6,0 x 1,0	0,13		
8,0 x 1,0	0,18		
10,0 x 1,0	0,23		
12,0 x 1,0	0,28		
12,0 x 1,5	0,39		
14,0 x 1,0	0,33		
15,0 x 1,0	0,35		
15,0 x 1,5	0,51		
16,0 x 1,0	0,38		
16,0 x 1,5	0,55		
16,0 x 2,0	0,70		
18,0 x 1,0	0,43		
18,0 x 1,5	0,62		
20,0 x 1,5	0,70		

KEEVITATUD, LÕÖMUTATUD

Mööd Ø mm	Kaal kg/m	EN 1.4301 AISI 304	EN 1.4404 AISI 316L
20,0 x 2,0	0,90		
22,0 x 1,5	0,77		
22,0 x 2,0	1,00		
25,0 x 1,5	0,88		
25,0 x 2,0	1,15		
28,0 x 1,5	1,00		
28,0 x 2,0	1,30		
30,0 x 1,5	1,07		
30,0 x 2,0	1,4		
32,0 x 1,5	1,15		
32,0 x 2,0	1,5		
35,0 x 2,0	1,65		
38,0 x 2,0	1,80		
42,0 x 2,0	2,00		

VENITATUD TORU



EN 10216-5 TC1

EN ISO 1127

Tolerantsid: D4/T3

Pikkus:
5000-7000 mm

Vastavustunnistus:
EN 10204/3.1

Mööd Ø mm	Kaal kg/m	EN 1.4301 AISI 304	EN 1.4404 AISI 316L
6,0 x 1,0	0,13		
6,0 x 1,5	0,17		
8,0 x 1,0	0,18		
8,0 x 1,5	0,24		
10,0 x 1,0	0,23		
10,0 x 1,5	0,32		
10,0 x 2,0	0,40		
12,0 x 1,0	0,28		
12,0 x 1,5	0,39		
12,0 x 2,0	0,50		
12,7 x 1,2	0,35		
13,2 x 2,3	0,62		
14,0 x 2,0	0,60		
15,0 x 1,0	0,35		
15,0 x 1,5	0,51		
16,0 x 2,0	0,70		
18,0 x 1,5	0,62		
18,0 x 2,0	0,80		
19,05 x 2,4	0,98		
20,0 x 2,0	0,90		
20,0 x 2,5	1,10		
22,0 x 2,0	1,00		
22,0 x 3,0	1,41		

LÕÖMUTATUD JA PEITSITUD

Mööd Ø mm	Kaal kg/m	EN 1.4301 AISI 304	EN 1.4404 AISI 316L
22,0 x 6,0	2,37		
25,0 x 2,0	1,15		
25,0 x 2,5	1,41		
25,0 x 3,0	1,65		
28,0 x 2,0	1,30		
28,0 x 2,5	1,60		
30,0 x 2,0	1,40		
30,0 x 3,0	2,02		
30,0 x 4,0	2,60		
35,0 x 3,0	2,37		
38,0 x 4,0	3,41		
42,0 x 3,0	2,93		
42,16 x 3,56	3,44		
48,26 x 3,68	4,12		
48,3 x 5,08	5,41		
60,3 x 5,54	7,49		
88,9 x 5,49	11,39		
88,9 x 7,62	15,52		
114,3 x 6,02	16,08		
114,3 x 8,56	22,70		
168,3 x 7,11	28,26		
168,3 x 10,97	43,25		
219,0 x 12,7	64,61		

PROTSESSITORUD

KEEVITATUD, LÕÖMUTAMATA JA PEITSITUD



EN 10217-7 TC1

EN ISO 1127

Pikkus: 6000 mm

Vastavustunnistus:
EN 10204/3.1

Mõõt Ø mm	Kaal kg/m	EN 1.4301 AISI 304	EN 1.4404 AISI 316L	Mõõt Ø mm	Kaal kg/m	EN 1.4301 AISI 304	EN 1.4404 AISI 316L
10,2 x 2,0	0,41			76,1 x 2,5	4,61		
13,5 x 2,3	0,65			76,1 x 3,0	5,49		
17,2 x 1,5	0,59			76,1 x 3,6	6,54		
17,2 x 2,3	0,86			76,1 x 5,0	8,90		
21,3 x 1,5	0,74			84,0 x 2,0	4,11		
21,3 x 2,0	0,97			88,9 x 1,5	3,28		
21,3 x 2,6	1,22			88,9 x 2,0	4,35		
25,0 x 1,2	0,70			88,9 x 2,5	5,41		
26,9 x 1,5	0,95			88,9 x 3,0	6,45		
26,9 x 2,0	1,25			88,9 x 4,0	8,50		
26,9 x 2,6	1,58			101,6 x 2,0	4,99		
32,0 x 2,0	1,50			101,6 x 3,0	7,41		
33,7 x 1,5	1,21			101,6 x 4,0	9,78		
33,7 x 2,0	1,59			103,0 x 1,5	3,81		
33,7 x 2,6	2,03			104,0 x 2,0	5,11		
33,7 x 3,2	2,44			114,3 x 1,5	4,24		
40,0 x 1,5	1,46			114,3 x 2,0	5,62		
42,4 x 1,5	1,54			114,3 x 2,5	7,00		
42,4 x 2,0	2,02			114,3 x 3,0	8,36		
42,4 x 2,6	2,59			114,3 x 4,0	11,05		
42,4 x 3,2	3,14			127,0 x 2,0	6,17		
44,5 x 1,5	1,62			129,0 x 1,5	4,75		
44,5 x 2,0	2,13			129,0 x 2,0	6,36		
48,3 x 1,5	1,76			139,7 x 1,5	5,19		
48,3 x 2,0	2,32			139,7 x 2,0	6,90		
48,3 x 2,6	2,98			139,7 x 2,5	9,93		
48,3 x 3,2	3,61			139,7 x 3,0	10,27		
50,0 x 1,0	1,23			139,7 x 4,0	13,59		
50,0 x 1,5	1,82			139,7 x 5,0	16,86		
50,8 x 1,5	1,85			154,0 x 2,0	7,61		
51,0 x 2,0	2,45			156,0 x 3,0	11,49		
53,0 x 1,5	1,93			157,0 x 6,0	22,34		
54,0 x 2,0	2,60			168,3 x 2,0	8,33		
60,3 x 1,5	2,21			168,3 x 2,5	10,38		
60,3 x 2,0	2,92			168,3 x 3,0	12,42		
60,3 x 2,6	3,76			168,3 x 4,0	16,46		
60,3 x 3,0	5,11			168,3 x 5,0	20,45		
60,3 x 3,6	5,11			195,0 x 8,0	36,89		
63,5 x 1,6	2,48			204,0 x 2,0	10,16		
70,0 x 2,0	3,41			219,1 x 2,0	10,87		
70,0 x 3,0	5,03			219,1 x 2,5	13,56		
76,1 x 1,5	2,80			219,1 x 3,0	16,23		
76,1 x 2,0	3,71			219,1 x 4,0	21,54		
				235,0 x 8,0	44,79		

JATKUB JÄRGMISEL LEHEKÜLJEL

 Lõõmutatud

 Lõõmutatud
ja lõõmutamata

PROTSESSITORUD



EN 10217-7 TC1
EN ISO 1127
Pikkus: 6000 mm
Vastavustunnistus:
EN 10204/3.1

KEEVITATUD, LÕÖMUTAMATA JA PEITSITUD

Mõõt Ø mm	Kaal kg/m	EN 1.4301 AISI 304	EN 1.4404 AISI 316L
256,0 x 3,0	19,01		
273,0 x 2,0	13,57		
273,0 x 2,5	16,93		
273,0 x 3,0	20,28		
273,0 x 4,0	26,94		
305,0 x 2,5	18,94		
323,9 x 2,0	16,12		
323,9 x 2,5	20,20		
323,9 x 3,0	24,11		

Mõõt Ø mm	Kaal kg/m	EN 1.4301 AISI 304	EN 1.4404 AISI 316L
323,9 x 4,0	32,04		
355,6 x 2,5	22,10		
355,6 x 3,0	26,49		
355,6 x 4,0	35,22		
406,4 x 3,0	30,30		
506,0 x 3,0	37,21		
508,0 x 4,0	50,48		
609,0 x 4,0	60,50		

VÄIKSEMAD SUURUSED
EELMISEL LEHEKÜLJEL

ASTM-TORUD



Mõõt Ø mm	Kaal kg/m	AISI 304	AISI 316L
48,3 x 2,77	3,155		
60,3 x 2,77	3,992		
88,9 x 5,49	11,466		
114,3 x 6,02	16,322		
141,3 x 6,55	22,101		
168,28 x 7,11	28,659		

Mõõt Ø mm	Kaal kg/m	AISI 304	AISI 316L
219,08 x 6,35	33,825		
219,08 x 8,18	43,198		
273,1 x 6,35	42,406		
273,1 x 9,27	61,229		
323,9 x 9,53	75,007		
508,0 x 5,54	69,702		

HARJATUD TORUD



EN ISO 1127
Pikkus: 6000 mm
Vastavustunnistus:
EN 10204/2.2

KEEVITATUD, LÕÖMUTAMATA JA HARJATTU

Mõõt Ø mm	Kaal kg/m	EN 1.4301 AISI 304
19,0 x 1,2	0,54	
25,0 x 1,2	0,72	
25,0 x 1,5	0,88	
26,09 x 2,0	1,25	
30,0 x 1,2	0,87	

Mõõt Ø mm	Kaal kg/m	EN 1.4301 AISI 304
32,0 x 1,5	1,15	
33,7 x 2,0	1,59	
33,7 x 3,0	2,30	
42,4 x 2,0	2,02	
48,3 x 2,0	2,32	

KAPILLAARTORUD

Pikkus: 4000-6000 mm

Vastavustunnistus: EN 10204/3.1

KEEVITATUD, LÕÖMUTATUD JA VENITATUD



Mõõt Ø mm	Kaal kg/m	EN 1.4404 AISI 316L
3,0 x 0,5	0,031	
4,0 x 0,5	0,044	
4,0 x 1,0	0,075	

Mõõt Ø mm	Kaal kg/m	EN 1.4404 AISI 316L
5,0 x 0,5	0,056	
5,0 x 1,0	0,100	
6,0 x 0,5	0,069	

MEIEREITORUD

Pikkus: 6000 mm

Vastavustunnistus: EN 10204/2.2

KEEVITATUD, LIHVITUD GRIT 320



Mõõt Ø mm	Kaal kg/m	EN 1.4301 AISI 304
25,0 x 1,2	0,72	
32,0 x 1,2	0,93	
38,0 x 1,2	1,11	
51,0 x 1,2	1,49	

Mõõt Ø mm	Kaal kg/m	EN 1.4301 AISI 304
63,5 x 1,5	2,33	
76,0 x 2,0	3,71	
101,6 x 2,0	4,99	

LIHVITUD TORUD

LÕÖMUTAMATA, LIHVITUD GRIT 320



EN ISO 1127

Pikkus: 6000 mm

Vastavustunnistus:
EN 10204/2.2

Mõõt Ø mm	Kaal kg/m	EN 1.4301 AISI 304, lihvitud	EN 1.4301 AISI 304, peegellihvitud	EN 1.4404 AISI 316L, lihvitud	EN 1.4404 AISI 316L, peegellihvitud
20,0 x 1,5	0,70				
21,3 x 2,0	0,95				
22,0 x 1,5	0,77				
25,0 x 1,5	0,88				
25,0 x 2,0	1,15				
26,9 x 2,0	1,23				
30,0 x 1,5	1,07				
32,0 x 1,5	1,15				
33,7 x 2,0	1,59				
35,0 x 1,5	1,24				
38,0 x 1,5	1,38				
38,0 x 2,0	1,81				
40,0 x 1,5	1,45				
40,0 x 2,0	1,90				
42,4 x 1,5	1,51				
42,4 x 2,0	2,02				
48,3 x 1,5	1,76				
48,3 x 2,0	2,32				
51,0 x 1,5	1,86				
60,3 x 2,0	2,92				
76,1 x 2,0	3,71				
88,9 x 2,0	4,35				
114,3 x 1,5	4,23				

 Lõõmutatud

KÄSIPUU TARVIKUD

Ø 40 MM TORU/PÖLV LIHVITUD, GRIT 320

Toode	EN 1.4301 AISI 304	Toote- koode
Pölv 40,0 x 1,5 90°, pikk		KO-2061
Pölv 40,0 x 1,5 30°		KO-2062
Liitmik		KO-2064
Löppkinniti		KO-2066
Löppkork		KO-2067
Seinakinniti Ø 60 mm		KO-2068
Seinakinniti M 12		KO-2069

Toode	EN 1.4301 AISI 304	Toote- koode
Seinakinniti (kruvi)		KO-2072
Ø 40 mm		
Ülemine kinnitus		KO-2073
Alumine kinnitus		KO-2074
Püsttoe alaosa plaat		KO-2075
Kinniti peiteseib Ø 60 mm		KO-2076

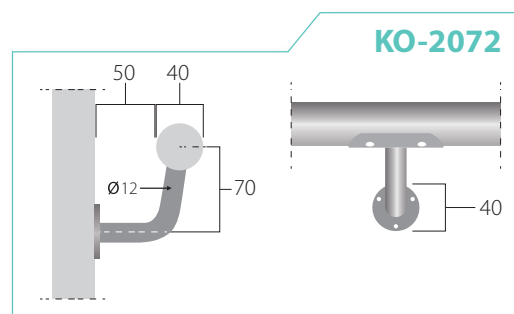
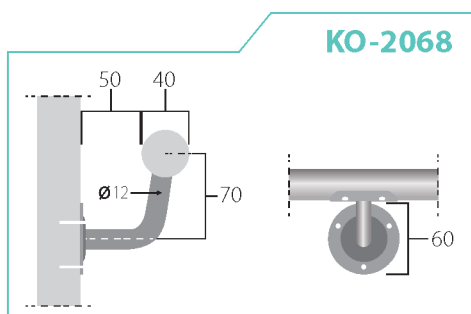
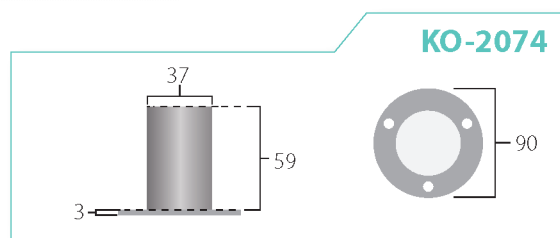
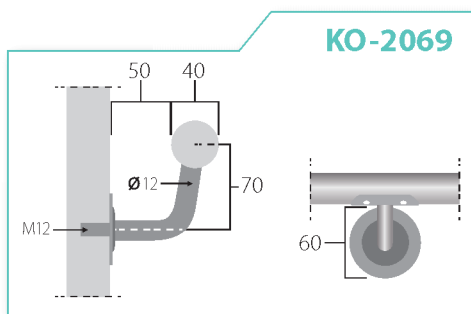
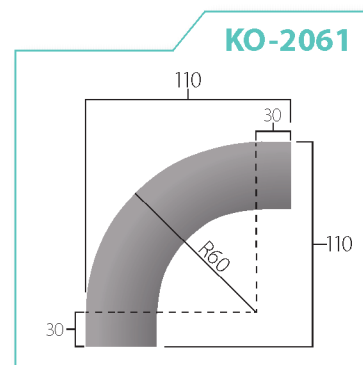
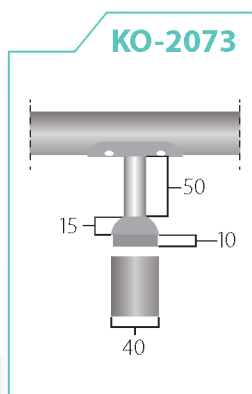
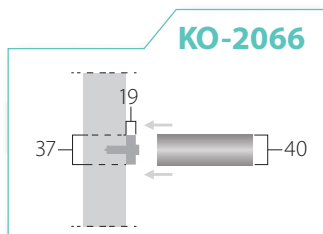
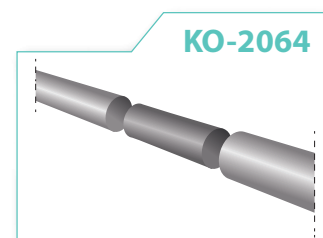
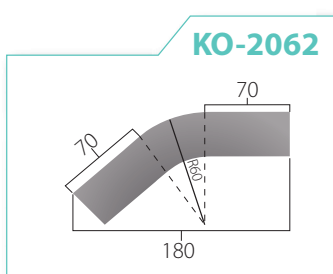
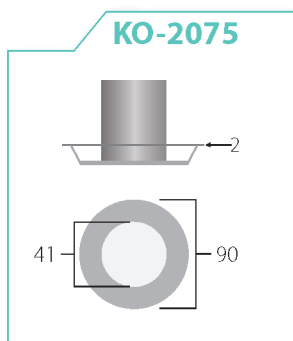

KÄSIPUU TARVIKUD

LIHVITUD 42,4 X 2,0 MM TORULE

Toode	Tunnus	Toote- kood
Pölv, 90°	AISI 304	KO-4061
Liide	AISI 304	KO-4064
Käsitoe ots	AISI 304	KO-4067
Seinakinniti (kruvi), D70	AISI 316	KO-4068
Ülemine kinnitus	AISI 316	KO-4073
Alumine kinnitus	AISI 304	KO-4074
Katterõngas, ilma kaeluseta, D100	AISI 304	KO-4075
Ülemine kinnitus, reguleeritav	AISI 316	KO-4077
Pölv reguleeritav	AISI 316	KO-4078
Kolmik	AISI 316	KO-4079
Nurk reguleeritav	AISI 316	KO-4080

Toode	Tunnus	Toote- kood
T-haara	AISI 316	KO-4079
Kulma, säädettävä	AISI 316	KO-4080
Terava nurgaga nurga tükk	AISI 316	KO-4085
Terava nurgaga nurga tükk	AISI 316	KO-4086
Seina kinnitus	AISI 316	KO-4090
Sadul ümarale tallaga	AISI 316	KO-4091
Klaasiklamber ümarale torule	AISI 316	KO-4092
Klaasiklambri tihend	AISI 316	KO-4093



NELIKANTTORU

KEEVITATUD, LIHVITUD
GRIT 320



Pikkus: 6000 mm

Vastavustunnistus:
EN 10204/2.2

Mõõt mm	Kaal kg/m	EN 1.4301 AISI 304 lihvitud	EN 1.4301 AISI 304	EN 1.4404 EN 1.4571 AISI 316L/Ti	EN 1.4404 EN 1.4751 AISI 316L/Ti lihvitud
10,0 x 10,0 x 1,0	0,29				
15,0 x 15,0 x 1,5	0,66				
20,0 x 20,0 x 1,0	0,61				
20,0 x 20,0 x 1,2	0,73				
20,0 x 20,0 x 1,5	0,90				
25,0 x 25,0 x 1,0	0,77				
25,0 x 25,0 x 1,2	0,92				
25,0 x 25,0 x 1,5	1,14				
25,0 x 25,0 x 2,0	1,49				
30,0 x 30,0 x 1,0	0,93				
30,0 x 30,0 x 1,2	1,11				
30,0 x 30,0 x 1,5	1,38				
30,0 x 30,0 x 2,0	1,81				
30,0 x 30,0 x 3,0	2,65				
35,0 x 35,0 x 1,5	1,62				
35,0 x 35,0 x 2,0	2,13				
40,0 x 40,0 x 1,0	1,25				
40,0 x 40,0 x 1,2	1,50				
40,0 x 40,0 x 1,5	1,86				
40,0 x 40,0 x 2,0	2,45				
40,0 x 40,0 x 3,0	3,60				
50,0 x 50,0 x 1,5	2,34				
50,0 x 50,0 x 2,0	3,09				
50,0 x 50,0 x 3,0	4,56				
50,0 x 50,0 x 4,0	5,98				
60,0 x 60,0 x 1,5	2,81				
60,0 x 60,0 x 2,0	3,73				
60,0 x 60,0 x 3,0	5,52				
60,0 x 60,0 x 4,0	7,25				
60,0 x 60,0 x 5,0	8,94				
70,0 x 70,0 x 3,0	6,47				
70,0 x 70,0 x 4,0	8,53				
80,0 x 80,0 x 2,0	5,00				
80,0 x 80,0 x 3,0	7,43				
80,0 x 80,0 x 4,0	9,81				
80,0 x 80,0 x 5,0	12,13				
100,0 x 100,0 x 3,0	9,34				
100,0 x 100,0 x 4,0	12,36				
100,0 x 100,0 x 5,0	15,32				
100,0 x 100,0 x 6,0	18,23				
120,0 x 120,0 x 4,0	14,91				
120,0 x 120,0 x 5,0	18,51				
120,0 x 120,0 x 6,0	22,07				
150,0 x 150,0 x 5,0	23,30				

RISTKÜLIKTORU



Pikkus: 6000 mm

Vastavustunnistus:
EN 10204/2.2

KEEVITATUD, LIHVITUD
GRIT 320

Mööd mm	Kaal kg/m	EN 1.4301 AISI 304 lihvitud	EN 1.4301 AISI 304	EN 1.4404 EN 1.4571 AISI 316L/Ti
20,0 x 15,0 x 1,5	0,78			
25,0 x 10,0 x 1,5	0,78			
25,0 x 15,0 x 1,0	0,61			
25,0 x 20,0 x 1,5	1,08			
30,0 x 20,0 x 1,0	0,77			
30,0 x 20,0 x 1,5	1,14			
40,0 x 20,0 x 1,5	1,38			
40,0 x 20,0 x 2,0	1,81			
50,0 x 20,0 x 1,5	1,82			
50,0 x 20,0 x 2,0	2,13			
50,0 x 25,0 x 1,5	1,76			
50,0 x 25,0 x 2,0	2,32			
50,0 x 30,0 x 1,5	1,86			
50,0 x 30,0 x 2,0	2,45			
50,0 x 30,0 x 3,0	3,60			
60,0 x 30,0 x 1,5	2,10			
60,0 x 30,0 x 2,0	2,77			
60,0 x 30,0 x 3,0	4,08			
60,0 x 40,0 x 1,5	2,34			
60,0 x 40,0 x 2,0	3,09			
60,0 x 40,0 x 3,0	4,56			
80,0 x 40,0 x 2,0	3,73			
80,0 x 40,0 x 3,0	5,52			
80,0 x 40,0 x 4,0	7,25			
80,0 x 60,0 x 3,0	6,47			
80,0 x 60,0 x 4,0	8,53			
100,0 x 40,0 x 3,0	6,47			
100,0 x 40,0 x 4,0	8,53			
100,0 x 50,0 x 2,0	4,68			
100,0 x 50,0 x 3,0	6,95			
100,0 x 50,0 x 4,0	9,17			
100,0 x 60,0 x 3,0	7,43			
100,0 x 60,0 x 4,0	9,81			
120,0 x 40,0 x 3,0	7,43			
120,0 x 60,0 x 3,0	8,39			
120,0 x 80,0 x 3,0	9,34			
120,0 x 80,0 x 4,0	12,36			
120,0 x 80,0 x 5,0	15,32			
150,0 x 50,0 x 3,0	9,34			
150,0 x 100,0 x 5,0	19,31			
200,0 x 100,0 x 5,0	23,30			

LEHED

KÜLMVALTS 2B



Vastavustunnistus:
EN 10204/3.1

Mööd Ø mm	Kaal kg/leht	EN 1.4301 AISI 304	EN 1.4404 AISI 316L
0,50 x 1000 x 2000	8,00		
0,60 x 1000 x 2000	10,00		
0,70 x 1000 x 2000	11,00		
0,80 x 1000 x 2000	13,00		
0,80 x 1250 x 2500	20,00		
0,80 x 1500 x 3000	29,00		
1,00 x 1000 x 2000	16,00		
1,00 x 1250 x 2500	25,00		
1,00 x 1500 x 3000	36,00		
1,25 x 1000 x 2000	20,00		
1,25 x 1250 x 2500	31,00		
1,25 x 1500 x 3000	45,00		
1,50 x 1000 x 2000	24,00		
1,50 x 1250 x 2500	38,00		
1,50 x 1500 x 3000	54,00		
2,00 x 1000 x 2000	32,00		
2,00 x 1250 x 2500	50,00		
2,00 x 1500 x 3000	72,00		
2,50 x 1000 x 2000	40,00		
2,50 x 1250 x 2500	63,00		
2,50 x 1500 x 3000	90,00		
3,00 x 1000 x 2000	48,00		
3,00 x 1250 x 2500	75,00		
3,00 x 1500 x 3000	108,00		
4,00 x 1000 x 2000	64,00		
4,00 x 1250 x 2500	100,00		
4,00 x 1500 x 3000	144,00		
5,00 x 1000 x 2000	80,00		
5,00 x 1250 x 2500	125,00		
5,00 x 1500 x 3000	180,00		
6,00 x 1500 x 3000	216,00		



Lihvitud



Lihvitud ja 2B

KUUMVALTS 1D



Mõõt Ø mm	Kaal kg/leht	EN 1.4301 AISI 304	EN 1.4404 AISI316L
3,0 x 1250 x 2500	75		
3,0 x 1500 x 3000	108		
4,0 x 1500 x 3000	144		
5,0 x 1500 x 3000	180		
6,0 x 1500 x 3000	216		
8,0 x 1500 x 3000	288		
10,0 x 1000 x 2000	160		
10,0 x 1500 x 3000	360		
12,0 x 1500 x 3000	432		
15,0 x 1500 x 3000	540		
20,0 x 1500 x 3000	720		
25,0 x 1500 x 3000	900		
30,0 x 1500 x 3000	1080		
35,0 x 1500 x 3000	1260		
40,0 x 1500 x 3000	1440		
50,0 x 1500 x 3000	1800		
60,0 x 1500 x 3000	2160		

TULEKINDLAD

Tugevus max. 223 HB

Vastavustunnistus:
EN 10204/3.1

VALTSITUD SAMMUTUSLÖÖMUTATUD

Mõõt Ø mm	Kaal kg/leht	EN 1.4828	Mõõt Ø mm	Kaal kg/leht	EN 1.4828
2 x 1000 x 2000	32,00		8 x 1000 x 2000	126,00	
3 x 1000 x 2000	48,00		10 x 1000 x 2000	157,00	
4 x 1000 x 2000	64,00		12 x 1000 x 2000	189,00	
5 x 1000 x 2000	80,00		15 x 1000 x 2000	236,00	
6 x 1000 x 2000	95,00		20 x 1000 x 2000	314,00	

TORUTARVIKUD

MEIEREIPÖLVED 90° JA 45°

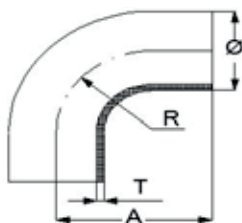

Pölv 1D 90°
SMS LIHVITUD



LAOS

Tootekood EN 1.4307	Tootekood EN 1.4404	Mööd Ø mm	T	R	A
AMK02512	BMK02512	25,0	1,2	25,0	55,0
AMK03212	BMK03112	32,0	1,2	32,0	64,0
AMK03812	BMK03812	38,0	1,2	38,0	70,0
AMK05112	BMK05112	51,0	1,2	51,0	82,0
AMK06315	BMK06315	63,5	1,6	63,5	105,0
AMK07620	BMK07620	76,0	2,0	76,0	110,0
AMK10120	BMK10220	101,6	2,0	110,0	150,0

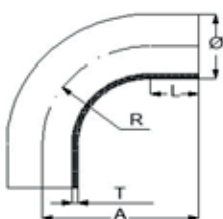

Pölv 1,5D 90°
SMS LIHVITUD



LAOS

Tootekood EN 1.4404	Mööd Ø mm	T	R	A	L
BMKL02512	25,0	1,2	37,5	65,0	27,5
BMKL03812	38,0	1,2	57,0	85,0	28,0
BMKL05112	51,0	1,2	76,5	110,0	33,5
BMKL06315	63,5	1,6	95,3	135,0	39,7
BMKL07616	76,0	1,6	114,0	155,0	40,8
BMKL10220	101,6	2,0	153,0	195,0	42,5

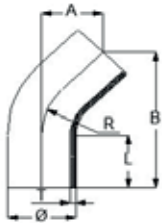

Põlv 45° SMS LIHVITUD



LAOS

Tootekood EN 1.4307	Tootekood EN 1.4404	Mõõt Ø mmLTRAB					
AMK0251245	BMK0251245	25,0	34,7	1,2	25,0	32,0	77,0
AMK0381245	BMK0381245	38,0	41,0	1,2	38,0	40,0	97,0
AMK0511245	BMK0511245	51,0	42,2	1,2	51,0	45,0	108,0
AMK0631545	BMK0631545	63,5	54,5	1,6	63,5	57,0	138,0
AMK0762045	BMK0761645	76,0	50,5	2,0	76,0	58,0	140,0
AMK1012045	BMK1022045	101,6	59,2	2,0	153,0	86,4	209,0

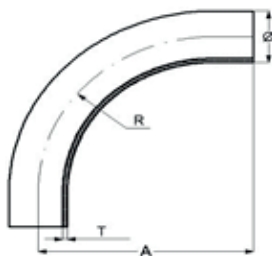

Kaar 3D SMS LIHVITUD



LAOS

Tootekood EN 1.4404	Mõõt Ø mm	T	R	A
BMKA025	25,0	1,5	75,0	115,0
BMKA038	38,0	1,5	115,0	140,0
BMKA051	51,0	1,5	150,0	225,0
BMKA063	63,5	1,5	185,0	240,0
BMKA076	76,1	2,0	215,0	250,0

MEIEREI ÜLEMINEKUD

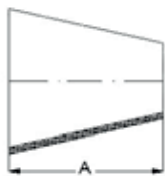

Üleminek KT SMS LIHVITUD

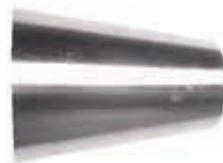

LAOS

Tootekood EN 1.4307	Tootekood EN 1.4404	Mõõt Ø mm	A
AMS322512		32,0 / 25,0	22,0
AMS382512	BMKS03802512	38,0 / 25,0	39,0
AMS512512	BMKS05102512	51,0 / 25,0	77,4
AMS513212		51,0 / 32,0	33,0
AMS513812	BMKS05103812	51,0 / 38,0	40,5
AMS643815	BMKS06303816	63,5 / 38,0	76,4
AMS645115	BMKS06305116	63,5 / 51,0	37,4
AMS765115	BMKS07605116	76,0 / 51,0	72,0
AMS766415	BMKS07606316	76,0 / 63,5	35,7
	BMKS10206320	101,6 / 63,5	105,0
	BMKS10207620	101,6 / 76,0	77,6

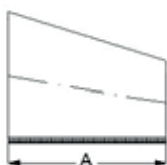

Üleminek ET SMS LIHVITUD



LAOS

Tuotekoodi EN 1.4404	Mitat Ø mm	A
BMKSE03802512	38 / 25	37,9
BMKSE05102512	51 / 25	75,5
BMKSE05103812	51 / 38	39,6
BMKSE06303812	63,5 / 38	71,0
BMKSE06305116	63,5 / 51	36,3
BMKSE07605116	76 / 51	70,2
BMKSE07606316	76 / 63,5	35,8
BMKSE10206320	101,6 / 63,5-	102,0
BMKSE10207620	101,6 / 76	76,1

MEIEREI KOLMIKUD

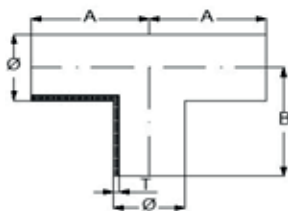

Meierei kolmikud SMS LIHVITUD



LAOS

Tootekood EN 1.4307	Mööt Ø mm	T	A	B
AMT02512	25,0	1,2	55	55
AMT03812	38,0	1,2	70	70
AMT05112	51,0	1,2	82	82
AMT06315	63,5	1,6	105	105
AMT07620	76,0	2,0	110	110
AMT10120	102,0	2,0	150	150

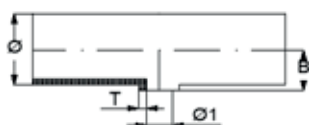

Meierei ülemineku kolmikud, venitatud SMS LIHVITUD



LAOS

Tootekood EN 1.4404	Mööt Ø mm	T	(sisemööt) Ø	B
BMT02512	25,0	1,2	22,6	14
BMTS03802512	38,0 / 25,0	1,2	22,6	22
BMT03812	38,0	1,2	35,6	22
BMTS05102512	51,0 / 25,0	1,2	22,6	29
BMTS05103812	51,0 / 38,0	1,2	35,6	29
BMT05112	51,0	1,2	48,6	29
BMTS06303812	63,5 / 38,0	1,6	35,6	35
BMTS06305116	63,5 / 51,0	1,6	48,6	35
BMT06315	63,5	1,6	60,5	35
BMTS07603816	76,0 / 38	2,0	35,6	41
BMTS07605116	76,0 / 51	2,0	48,6	41
BMTS07606316	76,0 / 63,5	2,0	60,5	41
BMT07615	76,0	2,0	72,0	41
BMTS10205120	101,6 / 51,0	2,0	48,6	55
BMTS10206320	101,6 / 63,5	2,0	60,5	55
BMTS10207620	101,6 / 76,0	2,0	72,0	55
BMT10220	101,6	2,0	97,6	55

PUTKISANGAT, MEJERI

Pressitud torukandur

LAOS

Tootekood EN 1.4301	Mõõt Ø mm
AMPS025	25,0
AMPS038	38,0
AMPS051	51,0
AMPS063	63,5
AMPS076	76,1
AMPS102	101,6

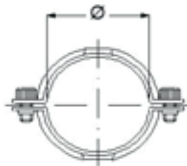

Pressitud torukandur jalaga

LAOS

Tootekood EN 1.4301	Mõõt Ø mm	Ø1	A
AMPSJ025	25,0	21,3	90
AMPSJ038	38,0	21,3	90
AMPSJ051	51,0	21,3	90
AMPSJ063	63,5	21,3	90
AMPSJ076	76,1	21,3	90
AMPSJ102	101,6	21,3	90



CLAMP-ÜHENDUSE OSAD

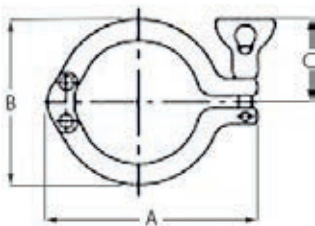

LAOS

Clamp-klamber

Tootekood AISI 304	Mõõt DN	A	B	C
BMCP025	25 / 38	92	65,2	52
BMCP051	51,0	105	78,7	52
BMCP063	63,5	123	92,2	52
BMCP076	76,0	137	105,7	52
BMCP102	101,6	170	133,7	52

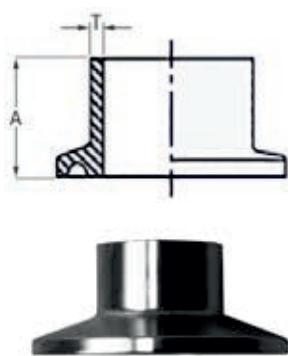

LAOS

Clamp-rõngas, keevitatav

Tootekood AISI 316L	Mõõt Ø mm	T	A
BMCR025	25,0 / 50,5	1,25	28,6
BMCR038	38,0 / 50,5	1,25	28,6
BMCR051	51,0 / 64,0	1,25	28,6
BMCR063	63,5 / 77,5	1,60	28,6
BMCR076	76,0 / 91,0	1,60	28,6
BMCR102	101,6 / 119,0	2,00	28,6

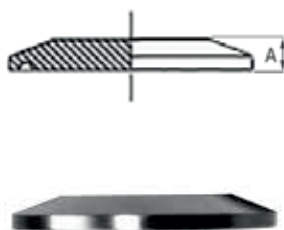

LAOS

Clamp-pimeseib

Tootekood AISI 304	Mõõt DN	Ø mm	A
BMCS038	25 / 38	50,5	6,3
BMCS051	51,0	64,0	6,3
BMCS063	63,5	77,5	6,3
BMCS076	76,0	91,0	6,3
BMCS102	101,6	119,0	7,9

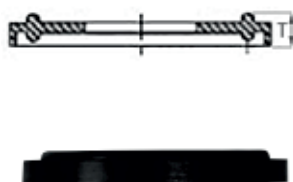

LAOS

Clamp-tihend EPDM ja Viton

Tootekood EPDM	Mõõt DN	Ø mm	T
BMCT025	25	50,5	5
BMCT038	38	50,5	5
BMCT051	51	64,0	5
BMCT063	63	77,5	5
BMCT076	76	91,0	5
BMCT102	104	119,0	5

MEIEREI ÜHENDUSE OSAD

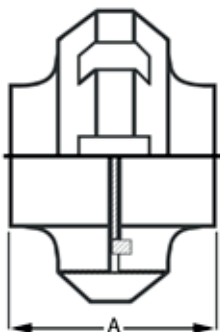

SMS ühendus



LAOS

Tootekood AISI 316L	Mõõt DN	A	Kierre
BMYO25	25,0	35,5	40 x 1/6"
BMYO38	38,0	40,0	60 x 1/6"
BMYO51	51,0	41,0	70 x 1/6"
BMYO63	63,5	45,0	85 x 1/6"
BMYO76	76,1	47,0	98 x 1/6"



SMS ühenduse keere,
keevitav



LAOS

Keevitav

Tootekood AISI 304	Tootekood AISI 316L	Mõõt DN	A	B	Tootekood AISI 304L
AMYK025	BMYP025	25,0	40 x 1/6"	20	
AMYK038	BMYP038	38,0	60 x 1/6"	23	
AMYK051	BMYP051	51,0	70 x 1/6"	25	AMYKM051
AMYK063	BMYP063	63,5	85 x 1/6"	30	AMYKM063
AMYK076	BMYP076	76,1	98 x 1/6"	35	AMYKM076
AMYK102	BMYP102	101,6	132 x 1/6"	30	



LAOS

Keevitav

Tootekood AISI 304L	Tootekood AISI 316L	Mõõt DN	A	B	Tootekood AISI 304L
AMYR025	BYMR025	25,0	25,4	17	AMYRM025
AMYR038	BYMR038	38,0	38,1	20	AMYRM038
AMYR051	BYMR051	51,0	51,0	20	AMYRM051
AMYR063	BYMR063	63,5	63,5	24	AMYRM063
AMYR076	BYMR076	76,1	76,2	30	AMYRM076
AMYR102	BYMR102	101,6	101,6	30	AMYRM102

SMS ühenduse mutter

LAOS

Tootekood AISI 304	Mõõt DN	A	B
BYM025	25,0	20	40 x 1/6"
BYM038	38,0	25	60 x 1/6"
BYM051	51,0	26	70 x 1/6"
BYM063	63,5	30	85 x 1/6"
BYM076	76,1	32	98 x 1/6"
BYM102	101,6	32	132 x 1/6"

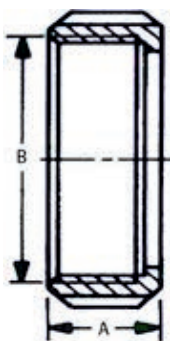

SMS ühenduse tihend EPDM

LAOS

Tootekood AISI 316L	Mõõt Ø mm	A	B
BYT025	25,0	5,5	32,0
BYT038	38,0	5,5	48,0
BYT051	51,0	5,5	61,0
BYT063	63,5	5,5	73,5
BYT076	76,1	5,5	86,0
BYT102	101,6	5,5	113,5

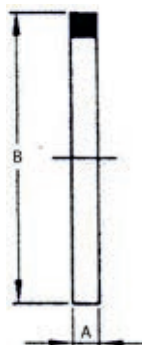

SILUMIIN VABA- JA KUUMTSINGITUD TERASÄÄRIKUD ÄÄRIKUD

VABAÄÄRIKUD



Poldi avad PN 10

Toru mõõt mm	Mõõt DN	Silumiin ALSI12Cu
17,2	10	4,90€/tk
21,3	15	5,20
26,9	20	7,60
33,7	25	8,50
42,4	32	11,90
48,3	40	12,80
60,3	50	16,20
76,1	65	19,70
88,9	80	22,70

Toru mõõt mm	Mõõt DN	Silumiin ALSI12Cu
114,3	100	23,20€/tk
139,7	125	31,80
168,3	150	38,90
219,1	200	53,00
273,0	250	64,00
323,9	300	76,00
355,6	350	101,00
406,4	400	120,00
508,0	500	180,00
609,4	600	283,90

TERAS VABA- JA PIMEÄÄRIKUD

KUUMTSINGITUD



Terasvabaäärikud:
EN 1092-1/2

pimeäärikud:
EN1092-1/05

Vastavustunnistus:
EN 10204/3.1

Toru mõõt mm	Mõõt DN	S235 JRG2		pime	
		vaba	PN		PN
17,2	10		PN 40		PN40
21,3	15		PN 40		PN40
26,9	20		PN 40		PN40
33,7	25		PN 40		PN40
42,4	32		PN 40		PN40
48,3	40		PN 40		PN40
60,3	50		PN 16		PN16
76,1	65		PN 16		PN16
88,9	80		PN 16		PN16
114,3	100		PN 16		PN16
139,7	125		PN 16		PN16
168,3	150		PN 16		PN16
219,1	200		PN 10		PN10
219,1	200		PN 16		
273,0	250		PN 10		
273,0	250		PN 16		
323,9	300		PN 10		
323,9	300		PN 16		
355,6	350		PN 10		
406,4	400		PN 10		
508,0	500		PN 10		
609,4	600		PN 10		
711,2	700		PN 10		
810	800		PN 10		

HAPPEKINDLAD

TREITUD ÄÄRIKUD JA KÆELUSED

TREITUD KÆELUSED



Vastavustunnistus:
EN 10204/3.1

EN1092-1 TYPE 35, PN 40

Tootekood	AISI DN/mm	316L
BHKE4010	10/17,2	
BHKE4015	15/21,3	
BHKE4020	20/26,9	
BHKE4025	25/33,7	
BHKE4032	32/42,4	
BHKE4040	40/48,3	
BHKE4050	50/60,3	

Tootekood	AISI DN/mm	316L
BHKE4080	80/88,9	
BHKE4100	100/114,3	
BHKE4125	125/139,7	
BHKE4150	150/168,3	
BHKE4200	200/219,1	
BHKE4250	250/273,0	

Vastavustunnistus:
EN 10204/3.1

PN 10

EN1092-1 TYPE 35, PN 16

Tootekood	AISI DN/mm	316L
BHKE1050	50/60,3	
BHKE1065	65/76,1	
BHKE1080	80/88,9	
BHKE1100	100/114,3	
BHKE1125	125/139,7	
BHKE1150	150/168,3	
BHKE1200	200/219,1	
BHKE1250	250/273,0	

Tootekood	AISI DN/mm	316L
BHKE1300	300/323,9	
BHKE0350	350/355,6	
BHKE0400	400/406,4	
BHKE0500	500/508,0	
BHKE0600	600/610,0	
BHKE0700	700/711,0	
BHKE0800	800/813,0	

VABAÄÄRIKUD



Vastavustunnistus:
EN 10204/3.1

EN1092-1/02, PN10 1.4404

Tootekood	DN/mm	PN	AISI 316L
BILE0200	200/219,1	10	
BILE0250	250/273,0	10	
BILE0300	300/323,9	10	
BILE0350	350/355,6	10	
BILE0400	400/406,4	10	
BILE0500	500/508	10	
BILE0600	600/609,8	10	
BILE0700	700/711,2	10	
BILE0800	800/813,0	10	

EN1092-1/02, PN16 1.4404

Vastavustunnistus:
EN 10204/3.1

Tootekood	DN/mm	PN	AISI 316L
BILE1050	50/60,3	16	
BILE1065	65/76,1	16	
BILE1065-8	65/76,1	16	
BILE1080	80/88,9	16	
BILE1100	100/114,3	16	
BILE1125	125/139,7	16	
BILE1150	150/168,3	16	
BILE1200	200/219,1	16	
BILE1250	250/273,0	16	
BILE1300	300/329,9	16	
BILE1310	350/355,6	16	
BILE1400	400/406,4	16	

EN1092-1/02, PN40 1.4404

Vastavustunnistus:
EN 10204/3.1

Tootekood	DN/mm	PN	AISI 316L
BILE4010	10/17,2	40	
BILE4015	15/21,3	40	
BILE4020	20/26,9	40	
BILE4025	25/33,7	40	
BILE4032	32/42,4	40	
BILE4040	40/48,3	40	
BILE4050	40/48,3	40	

PIMEÄÄRIKUD



Vastavustunnistus:
EN 10204/3.1

EN1092-1/05, PN10 1.4404

Tootekood	DN/mm	PN	AISI 316L
BULE0200	200	10	
BULE0250	250	10	
BULE0300	300	10	
BULE0350	350	10	
BULE0400	400	10	
BULE0600	600	10	

Vastavustunnistus:
EN 10204/3.1

EN1092-1/05, PN16 1.4404

Tootekood	DN/mm	PN	AISI 316L
BULE1050	50	16	
BULE1065	65	16	
BULE1065-8	65	16	
BULE1080	80	16	
BULE1100	100	16	
BULE1125	125	16	
BULE1150	150	16	
BULE1200	200	16	
BULE1250	250	16	
BULE1300	300	16	
BULE1350	350	16	
BULE1400	400	16	

Vastavustunnistus
EN 10204/3.1

EN1092-1/05, PN40 1.4404

Tootekood	DN/mm	PN	AISI 316L
BULE4010	10	40	
BULE4015	15	40	
BULE4020	20	40	
BULE4025	25	40	
BULE4032	32	40	
BULE4040	40	40	
BULE4050	50	40	
BULE4065	65	40	
BULE4080	80	40	
BULE4100	100	40	
BULE4125	125	40	
BULE4150	150	40	
BULE4200	200	40	

KAELUSÄÄRIKUD



Vastavustunnistus:
EN 10204/3.1

EN1092-1/11, PN10 1.4404

Tootekood	DN/mm	PN	AISI 316L
BKLE0200	200/219,1	10	
BKLE0250	250/273,0	10	
BKLE0300	300/323,9	10	
BKLE0350	350/355,6	10	
BKLE0400	400/406,4	10	
BKLE0500	500/508,0	10	
BKLE0600	600/609,6	10	

Vastavustunnistus:
EN 10204/3.1

EN1092-1/11, PN16 1.4404

Tootekood	DN/mm	PN	AISI 316L
BKLE1050	50/60,3	16	
BKLE1065	65/76,1	16	
BKLE1065-8	65/76,1	16	
BKLE1080	80/88,9	16	
BKLE1100	100/114,3	16	
BKLE1125	125/139,7	16	
BKLE1150	150/168,3	16	
BKLE1200	200/219,1	16	
BKLE1250	250/273,0	16	
BKLE1300	300/329,9	16	
BKLE1350	350/355,6	16	
BKLE1400	400/406,4	16	

Vastavustunnistus:
EN 10204/3.1

EN1092-1/11, PN40 1.4404

Tootekood	DN/mm	PN	AISI 316L
BKLE4010	10/17,2	40	
BKLE4015	15/21,3	40	
BKLE4020	20/26,9	40	
BKLE4025	25/33,7	40	
BKLE4032	32/42,4	40	
BKLE4040	40/48,3	40	
BKLE4050	50/60,3	40	
BKLE4065	65/76,1	40	
BKLE4080	80/88,9	40	
BKLE4100	100/114,3	40	
BKLE4125	125/139,7	40	
BKLE4150	150/168,3	40	
BKLE4200	200/219,1	40	

KEEVITATAVAD ÄÄRIKUD



Vastavustunnistus:
EN 10204/3.1

EN1092-1/01, PN10 1.4404

Tootekood	DN/mm	PN	AISI 316L
BHLE0200	200/219,1	10	
BHLE0250	250/273,0	10	
BHLE0300	300/323,9	10	
BHLE0350	350/355,6	10	
BHLE0400	400/406,4	10	
BHLE0500	500/508	10	
BHLE0600	600/609,6	10	

Vastavustunnistus:
EN 10204/3.1

EN1092-1/01, PN16 1.4404

Tootekood	DN/mm	PN	AISI 316L
BHLE1050	50/60,3	16	
BHLE1065	65/76,1	16	
BHLE1065-8	65/76,1	16	
BHLE1080	80/88,9	16	
BHLE1100	100/114,3	16	
BHLE1125	125/139,7	16	
BHLE1150	150/168,3	16	
BHLE1200	200/219,1	16	
BHLE1250	250/273,0	16	
BHLE1300	300/329,9	16	
BHLE1350	350/355,6	16	
BHLE1400	400/406,4	16	

Vastavustunnistus:
EN 10204/3.1

EN1092-1/05, PN40 1.4404

Tootekood	DN/mm	PN	AISI 316L
BHLE4010	10/17,2	40	
BHLE4015	15/21,3	40	
BHLE4020	20/26,9	40	
BHLE4025	25/33,7	40	
BHLE4032	32/42,4	40	
BHLE4040	40/48,3	40	
BHLE4050	50/60,3	40	
BHLE4125	125/139,7	40	

ASTM:

VABAAÄRIKUD



Vastavustunnistus:
EN 10204/3.1

ASTM/ASME A/SA182 B16.5

Tootekood	Suurus	Lbs	AISI 316L
BILS10015	1/2"	150	
BILS10034	3/4"	150	
BILS10100	1"	150	
BILS10114	1 1/4"	150	
BILS10115	1 1/2"	150	
BILS10200	2"	150	
BILS10215	2 1/2"	150	
BILS10300	3"	150	
BILS10400	4"	150	
BILS10500	5"	150	
BILS10600	6"	150	
BILS10800	8"	150	
BILS11000	10"	150	

PIMEÄÄRIKUD



Vastavustunnistus:
EN 10204/3.1

ASTM/ASME A/SA182 RF B16.5

Tootekood	Suurus	Lbs	AISI 316L
BULS10015	1/2"	150	
BULS10034	3/4"	150	
BULS10100	1"	150	
BULS10114	1 1/4"	150	
BULS10115	1 1/2"	150	
BULS10200	2"	150	
BULS10215	2 1/2"	150	
BULS10300	3"	150	
BULS10400	4"	150	
BULS10500	5"	150	
BULS10600	6"	150	
BULS10800	8"	150	
BULS11000	10"	150	

ASTM:

KAELUSÄÄRIKUD



Vastavustunnistus:
EN 10204/3.1

ASTM/ASME A/SA182 RF B16.5

Tootekood	Koko	Lbs	AISI 316L
BKLS10015	1/2" Sch 405	150	
BKLS10034	3/4" Sch 405	150	
BKLS10100	1" Sch 405	150	
BKLS10114	1 1/4" Sch 405	150	
BKLS10115	1 1/2" Sch 405	150	
BKLS10200	2" Sch 405	150	
BKLS10215	2 1/2" Sch 40	150	
BKLS10300	3" Sch 10	150	
BKLS10400	4" Sch 10	150	
BKLS10500	5" Sch 10	150	
BKLS10600	6" Sch 10	150	
BKLS10800	8" Sch 10	150	
BKLS11000	10" Sch 10	150	

KEEVITATAVAD ÄÄRIKUD



Vastavustunnistus:
EN 10204/3.1

ASTM/ASME A/SA182 RF B16.5

Tootekood	Koko	Lbs	AISI 316L
BHLS10015	1/2"	150	
BHLS10034	3/4"	150	
BHLS10100	1"	150	
BHLS10114	1 1/4"	150	
BHLS10115	1 1/2"	150	
BHLS10200	2"	150	
BHLS10215	2 1/2"	150	
BHLS10300	3"	150	
BHLS10400	4"	150	
BHLS10500	5"	150	
BHLS10600	6"	150	
BHLS10800	8"	150	
BHLS11000	10"	150	

HAPPEKINDLAD

VENTIILID JA MUDAERALDAJAD

KUULVENTIILID



1 OSA

POOLAVA

Tootekood	R	PN	AISI 316
8108	1/4"	64	
8110	3/8"	64	
8115	1/2"	64	
8120	3/4"	64	
8125	1"	64	
8132	1 1/4"	64	
8140	1 1/2"	40	
8150	2"	40	
8165	2 1/2"	40	
8180	3"	40	



2 OSA

TÄISAVA

Tootekood	R	PN	AISI 316
8208	1/4"	64	
8210	3/8"	64	
8215	1/2"	64	
8220	3/4"	64	
8225	1"	64	
8232	1 1/4"	64	
8240	1 1/2"	40	
8250	2"	40	
8265	2 1/2"	40	
8280	3"	40	



3 OSA

KEEVITATAV TÄISAVA

Tootekood	R	PN	AISI 316
8308	8/13,5	64	
8310	10/17,2	64	
8315	15/21,3	64	
8320	20/26,9	64	
8325	25/33,7	64	
8332	32/42,4	64	
8340	40/48,3	64	
8350	50/60,3	64	
8365	65/76,1	40	
8380	80/88,9	40	
8390	100/114,3	40	

KUULVENTIILID



KOLM-TEE

Tootekood	R	PN	AISI 316
8515	1/2"	64	
8520	3/4"	64	
8525	1"	64	
8532	1 1/4"	64	
8540	1 1/2"	64	
8550	2"	64	



KOKKUPANDAV, TÄISAVA

Tootekood	R	PN	AISI 316
8408	1/4"	64	
8410	3/8"	64	
8415	1/2"	64	
8420	3/4"	64	
8425	1"	64	
8432	1 1/4"	64	
8440	1 1/2"	64	
8450	2"	40	

MUDAERALDAJA



Tootekood	R	PN	AISI 316
8808	1/4"	40	
8810	3/8"	40	
8815	1/2"	40	
8820	3/4"	40	
8825	1"	40	
8832	1 1/4"	40	
8840	1 1/2"	40	
8850	2"	40	

NÕELVENTIIL



Tootekood	R	PN	AISI 316
8008	1/4"	400	
8010	3/8"	400	
8015	1/2"	400	
8020	3/4"	400	
8025	1"	400	

TAGASILOÖGI KLAPP



Tootekood	R	PN	AISI 316
8908	1/4"	40	
8910	3/8"	40	
8915	1/2"	40	
8920	3/4"	40	
8925	1"	40	
8932	1 1/4"	40	
8940	1 1/2"	40	
8950	2"	40	

PRESSPÕLVED 90°

Presspoojen 90° S/S

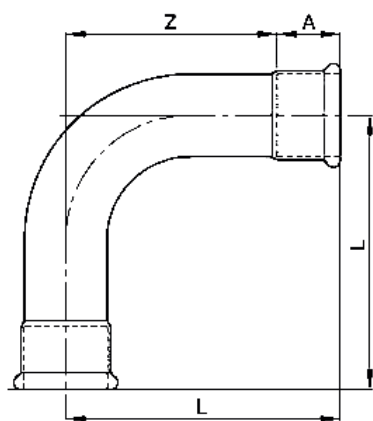

LAOS

PRESSPOOGEN 90° S/S

Tootekood	Mõõt Ø mm	A	L	Z
15035001	15	20	56	36
15035003	18	21	61	40
15035005	22	21	72	51
15035007	28	24	83	59
15035009	35	27	93	66
15035011	42	32	108	76
15035013	54	38	125	87
15035015	76,1	55	180	125
15035017	88,9	64	191	127
15035019	108	78	250	172

Presspoojen 90° S/V

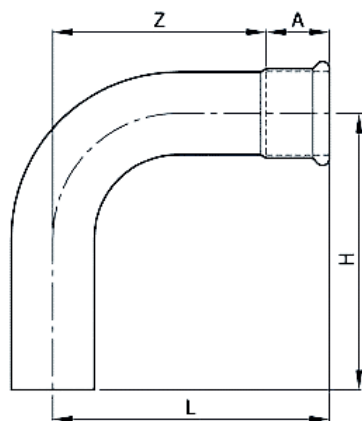

LAOS

Tootekood	Mõõt Ø mm	A	H	L	Z
15035101	15	20	62	56	36
15035103	18	21	67	61	40
15035105	22	21	83	72	51
15035107	28	24	91	83	59
15035109	35	27	96	93	66
15035111	42	32	112	108	76
15035113	54	38	130	125	87
15035115	76,1	55	187	180	125
15035117	88,9	64	199	191	127
15035119	108	78	259v	250	172

LAOS

PRESSPÖLV 90° SK

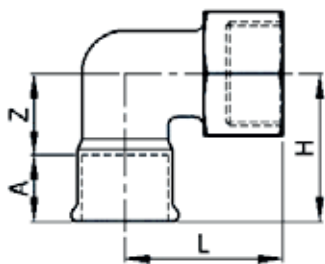

Tootekood	Mõõt Ø mm	Keere	A	H	L	Z
15036001	15	1/2"	20	47	29	27
15036003	18	1/2"	21	48	30	27
15036005	22	3/4"	21	53	35	32
15036007	28	1"	24	61	41	37
15036009	35	1 1/4"	27	70	49	43

LAOS

PRESSPÖLV 90° VK

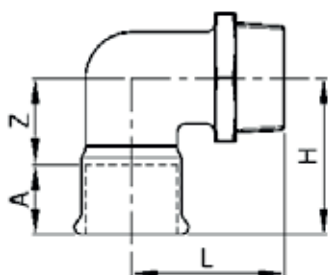

Tootekood	Mõõt Ø mm	Keere	A	H	L	Z
15036051	15	1/2"	20	47	33	27
15036053	18	1/2"	21	48	34	27
15036055	22	3/4"	21	54	41	33
15036057	28	1"	24	60	45	36
15036059	35	1 1/4"	27	70	59	43
15036061	42	1 1/2"	32	79	60	52
15036063	54	2"	38	92	74	54

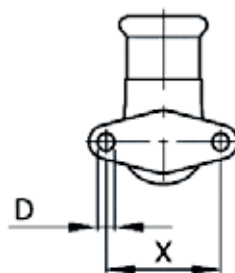
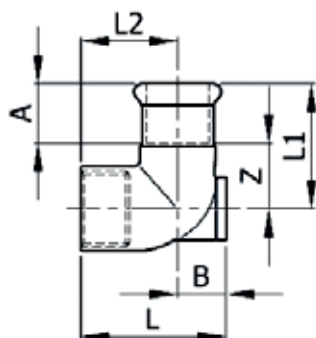

LAOS

PRESSKRAANIPÖLV 90°

Tootekood	Mõõt Ø mm	Keere	B	D	L	L1	L2	X	Z
15036101	15	1/2"	13	5	43	48	30	34	28
15036103	18	1/2"	13	5	43	49	30	34	28
15036105	22	3/4"	17	6	51	53	34	40	32

PRESSPÖLVED 45°

LAOS

PRESSPÖLV 45° SK/SK

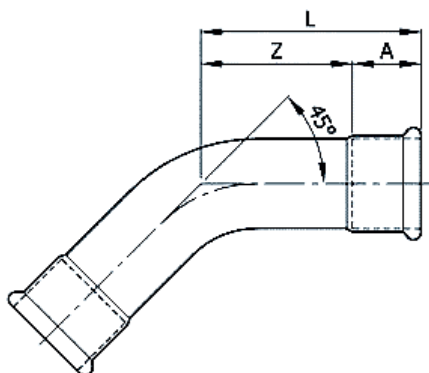

Tootekood	Möötl Ø mm	A	L	Z
15035401	15	20	45	25
15035403	18	21	51	30
15035405	22	21	57	36
15035407	28	24	63	39
15035409	35	27	68	41
15035411	42	32	78	46
15035413	54	38	87	49
15035415	76,1	55	126	71
15035417	88,9	64	128	64
15035419	108	78	155	77

LAOS

PRESSPÖLV 45° SK/VK

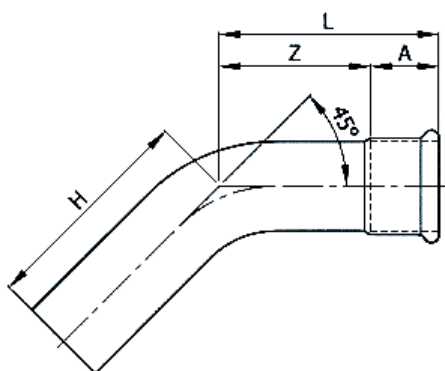

Tootekood	Möötl Ø mm	A	H	L	Z
15035501	15	20	48	45	25
15035503	18	21	55	51	30
15035505	22	21	61	57	36
15035507	28	24	68	63	39
15035509	35	27	71	68	41
15035511	42	32	82	78	46
15035513	54	38	92	87	49
15035515	76,1	55	133	126	71
15035517	88,9	64	136	128	64
15035519	108	78	164	155	77

MUHVID

LAOS

PRESSMUHV

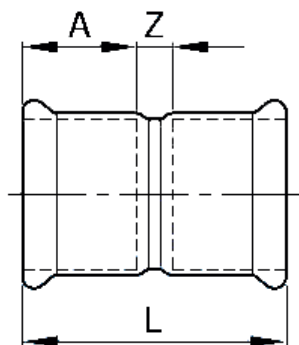

Tootekood	Möötl Ø mm	A	L	Z
15036301	15	20	48	8
15036303	18	21	50	8
15036305	22	21	51	9
15036307	28	24	56	8
15036309	35	27	68	14
15036311	42	32	74	10
15036313	54	38	94	18
15036315	76,1	55	125	15
15036317	88,9	64	144	16
15036319	108	78	172	16

LAOS

PRESS LIUGMUHV

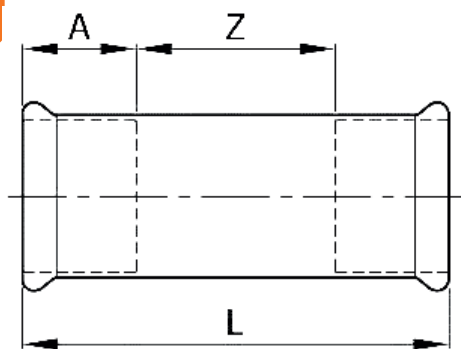

Tootekood	Mõõt Ø mm	A	L	Z
15036351	15	20	80	40
15036353	18	21	80	38
15036355	22	21	84	42
15036357	28	24	90	42
15036359	35	27	102	48
15036361	42	32	120	56
15036363	54	38	139	63
15036365	76,1	55	226	116
15036367	88,9	64	255	127
15036369	108	78	304	148

PRESSKORK

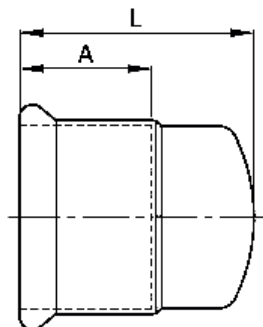
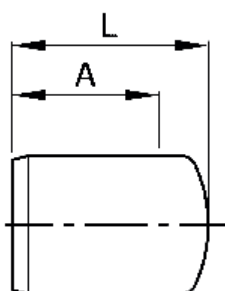

LAOS

Tootekood	Mõõt Ø mm	A	L
15037201	15	20	59
15037203	18	21	63
15037205	22	21	66
15037207	28	24	75
15037209	35	27	83
15037211	42	32	104
15037213	54	38	118
15037215	76,1	55	172
15037217	88,9	64	192
15037219	108	78	226

LAOS

Tootekood	Mõõt Ø mm	A	L
15037231	15	20	28
15037233	18	21	29,5
15037235	22	21	31
15037237	28	24	47
15037239	35	27	48
15037241	42	32	58
15037243	54	38	65
15037245	76,1	55	97,5
15037247	88,9	64	104,5
15037249	108	78	125,5

LIITMIKUD

LAOS

PRESSLIITMIK VK

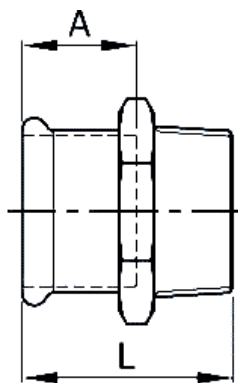

Tootekoodi	Mööd Ø mm	Keere	A	L
15036451	15	1/2"	20	43,6
15036452	15	3/4"	20	46
15036453	18	1/2"	21	43,3
15036455	18	3/4"	21	46
15036456	22	1/2"	21	43,5
15036457	22	3/4"	21	46
15036458	22	1"	21	48
15036445	28	1/2"	24	43,5
15036447	28	3/4"	24	46
15036459	28	1"	24	48
15036449	28	1 1/4"	24	51
15036460	35	1"	27	69
15036461	35	1 1/4"	27	72
15036462	35	1 1/2"	27	72
15036464	42	1 1/4"	32	78
15036463	42	1 1/2"	32	78
15036466	54	1 1/2"	38	86
15036465	54	2"	38	90
15036467	76,1	2 1/2"	55	132
15036469	88,9	3"	64	140

LAOS

PRESSLIITMIK SK

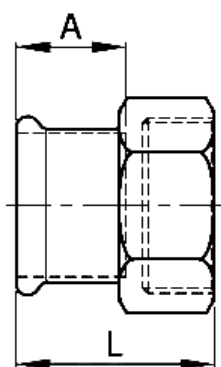

Tootekood	Mööd Ø mm	Keere	A	L
15036401	15	1/2"	20	39
15036402	15	3/4"	20	42
15036403	18	1/2"	21	39
15036404	18	3/4"	21	42
15036407	22	1/2"	21	39
15036409	22	3/4"	21	42
15036405	22	1"	21	45
15036419	28	1/2"	24	57
15036406	28	3/4"	24	44
15036411	28	1"	24	47
15036408	28	1 1/4"	24	49
15036412	35	1"	27	63
15036413	35	1 1/4"	27	67
15036414	35	1 1/2"	27	67
15036416	42	1 1/4"	32	73
15036415	42	1 1/2"	32	73
15036418	54	1 1/2"	38	79
15036417	54	2"	38	98

ÜHENDUSED

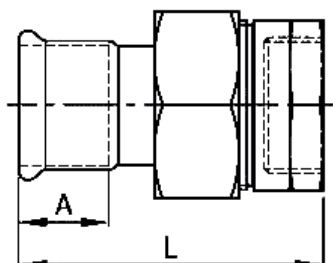

LAOS

PRESSÜHENDUSED SK

Tootekood	Mõõt Ø mm	Keere	A	L
15036851	15	1/2"	20	78
15036850	15	3/4"	20	79,5
15036853	18	1/2"	21	78
15036852	18	3/4"	21	78
15036855	22	3/4"	21	83
15036856	22	1"	21	86
15036857	28	1"	24	91
15036859	35	1 1/4"	27	98
15036861	42	1 1/2"	32	108
15036863	54	2"	38	130

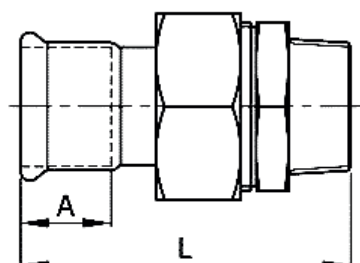

LAOS

PRESSÜHENDUSED VK

Tootekood	Mõõt Ø mm	Keere	A	L
15036871	15	1/2"	20	83
15036870	15	3/4"	20	85
15036873	18	1/2"	21	83
15036872	18	3/4"	21	85
15036874	22	1/2"	21	86
15036875	22	3/4"	21	88
15036876	22	1"	21	93
15036877	28	1"	24	98
15036879	35	1 1/4"	27	106
15036881	42	1 1/2"	32	117
15036883	54	2"	38	139

KOLMIKUD

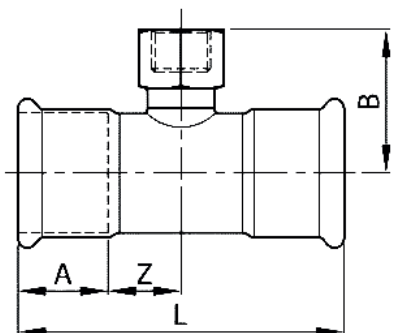

LAOS

PRESS T-ÜHENDUSED

Tootekood	Mööd Ø mm	Keere	A	B	L	Z
15036801	15	1/2"	20	35,2	66	13
15036803	18	1/2"	21	36,7	68	13
15036807	22	1/2"	21	39	80	19
15036809	22	3/4"	21	42	80	19
15036811	28	1/2"	24	42	88	20
15036813	28	3/4"	24	45	88	20
15036815	35	1/2"	27	44,5	105	25,5
15036817	35	3/4"	27	47,5	105	25,5
15036819	42	1/2"	32	48	116	25
15036821	42	3/4"	32	51	116	25
15036823	54	1/2"	38	55	142	33
15036825	54	3/4"	38	58	142	33
15036827	54	2"	38	79	142	33
15036829	76,1	3/4"	55	69	242	66
15036835	76,1	2"	55	90	242	66
15036831	88,9	3/4"	64	76	250	61
15036837	88,9	2"	64	97	250	61
15036833	108	3/4"	78	85	310	77
15036839	108	2"	78	106	310	77

LAOS

PRESS T-ÜHENDUSED

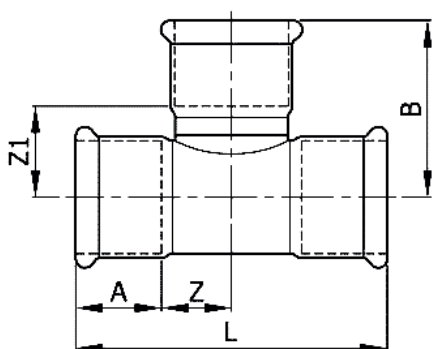

Tootekood	Mööd Ø mm	A	B	L	Z	Z1
15036601	15	20	38,2	66	13	18,2
15036603	18	21	40,7	68	13	19,7
15036605	22	21	44	80	19	23
15036607	28	24	50	88	20	26
15036609	35	27	56,5	105	25,5	29,5
15036611	42	32	66	116	25	34
15036613	54	38	79	142	33	41
15036615	76,1	55	116,5	242	66	61,5
15036617	88,9	64	128	250	63,5	64
15036619	108	78	154,5	310	77	76,5

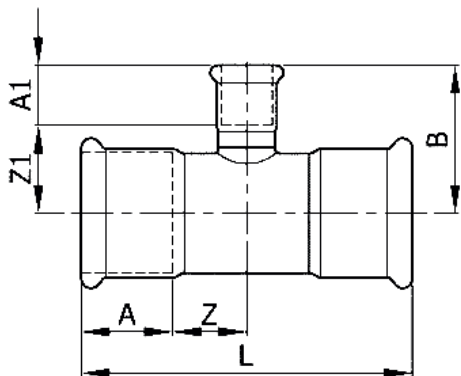

LAOS

PRESS AHENEV T-ÜHENDUSED

Tootekood	Mööd Ø mm	A	A1	B	L	Z	Z1
15036701	18-15	21	20	39,7	68	13	19,7
15036703	22-15	21	20	42	80	19	22
15036705	22-18	21	21	43	80	19	22
15036707	28-15	24	20	45	88	20	25
15036709	28-18	24	21	46	88	20	25
15036711	28-22	24	21	47	88	20	26
15036713	35-15	27	20	47,5	105	25,5	27,5
15036715	35-18	27	21	48,5	105	25,5	27,5
15036717	35-22	27	21	49,5	105	25,5	28,5
15036719	35-28	27	24	52,5	105	25,5	28,5
15036720	42-15	32	20	51	116	25	31
15036722	42-18	32	21	52	116	25	31
15036721	42-22	32	21	53	116	25	32
15036723	42-28	32	24	56	116	25	32
15036725	42-35	32	27	60	116	25	33
15036724	54-15	38	20	58	142	33	38
15036726	54-18	38	21	59	142	33	38
15036727	54-22	38	21	60	142	33	39
15036729	54-28	38	24	63	142	33	39
15036731	54-35	38	27	67	142	33	40
15036733	54-42	38	32	73	142	33	41
15036735	76,1-22	55	21	71	242	66	50
15036737	76,1-28	55	24	74	242	66	50
15036739	76,1-35	55	27	78	242	66	51
15036741	76,1-42	55	32	84	242	66	52
15036743	76,1-54	55	38	90	242	66	52
15036745	88,9-22	64	21	78	250	61	57
15036747	88,9-28	64	24	81	250	61	57
15036749	88,9-35	64	27	85	250	61	58
15036751	88,9-42	64	32	91	250	61	59
15036753	88,9-54	64	38	97	250	61	59
15036755	88,9-76,1	64	55	123,5	250	61	68,5
15036757	108-22	78	21	87	310	77	66
15036759	108-28	78	24	90	310	77	66
15036761	108-35	78	27	94	310	77	67
15036763	108-42	78	32	100	310	77	68
15036765	108-54	78	38	106	310	77	68
15036767	108-76,1	78	55	132,5	310	77	77,5
15036769	108-88,9	78	64	137,5	310	77	73,5

KUULVENTIILID

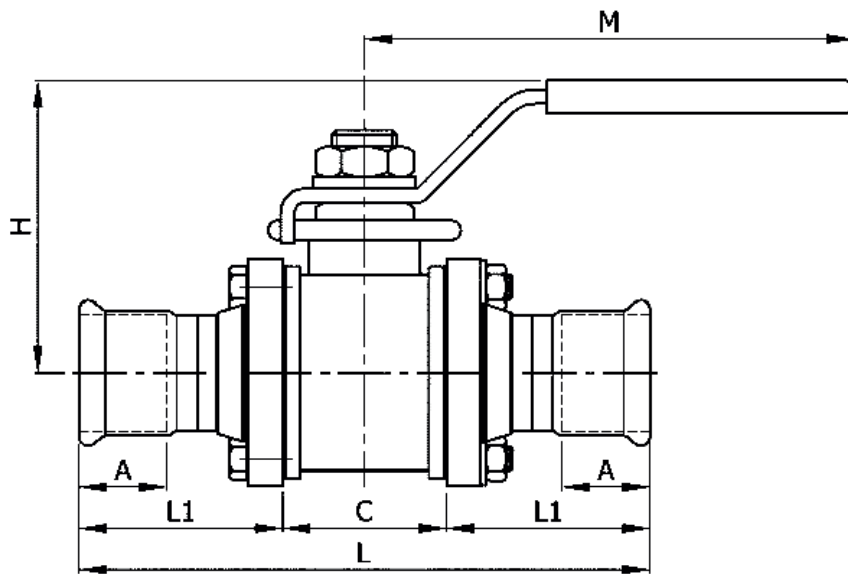

LAOS

PRESS KUULVENTIILID TÄISAVA

Tootekood	Mõõt Ø mm	A	C	H	L	L1	M
14984800	15	20	22	57	118	48	105
14984799	18	21	23,4	62	119,4	48	110
14984801	22	21	31	67	133	51	110
14984802	28	24	37,9	85	147,9	55	130
14984803	35	27	47	85	177	65	130
14984804	42	32	57	100	203	73	160
14984805	54	38	68	110	230	81	160



ÜLEMINEKUD

LAOS

PRESS ÜLEMINEKUD

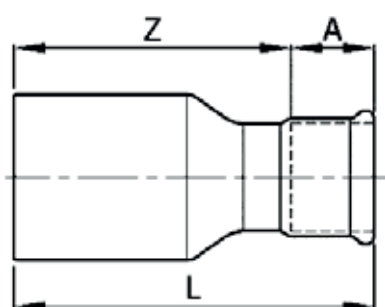

Tootekood	Mööd Ø mm	A	L	Z
15036901	18-15	20	62,5	42,5
15036903	22-15	20	72,5	52,5
15036905	22-18	21	70,5	49,5
15036907	28-15	20	80	60
15036909	28-18	21	74	53
15036911	28-22	21	77	56
15036912	35-15	20	81	61
15036917	35-22	21	85	64
15036919	35-28	24	83,5	59,5
15036925	42-22	21	91	70
15036927	42-28	24	96,5	72,5
15036929	42-35	27	103	76
15036937	54-28	24	117,5	93,5
15036939	54-35	27	116,5	89,5
15036941	54-42	32	117,5	85,5
15036943	76,1-42	32	157	125
15036945	76,1-54	38	157	119
15036947	88,9-54	38	168,5	130,5
15036949	88,9-76,1	55	179,5	124,5
15036951	108-54	38	182	144
15036953	108-76,1	55	208	153
15036955	108-88,9	64	204	152

PRESSTORUD

LAOS

EN 10312/10217-7 TC1

Tolerantsid: D4/T3

Pikkus: 6000 mm

Materjali sertifikaat:
EN 10204/3.1

Mööd Ø mm	Paine kg/m	EN 1.4404 AISI 316L
15,0 x 1,0	0,35	
18,0 x 1,0	0,43	
22,0 x 1,2	0,62	
28,0 x 1,2	0,79	
35,0 x 1,5	1,24	
42,0 x 1,5	1,54	
54,0 x 1,5	1,94	
76,1 x 2,0	3,71	
88,9 x 2,0	4,35	
108,0 x 2,0	5,23	

HAPPEKINDLAD SURVELIITMIKUD

LÕPPLIIDE



Tootekood	mm/R	PN	EN 1.4571
060606	6 x LR 1/8"	250	
060608	6 x LR 1/4"	250	
060610	6 x LR 3/8"	250	
060806	8 x LR 1/8"	250	
060808	8 x LR 1/4"	250	
060810	8 x LR 3/8"	250	
060815	8 x LR 1/2"	250	
061008	10 x LR 1/4"	250	
061010	10 x LR 3/8"	250	
061015	10 x LR 1/2"	250	
061208	12 x LR 1/4"	250	
061210	12 x LR 3/8"	250	
061215	12 x LR 1/2"	250	
061515	15 x LR 1/2"	250	
061615	16 x SR 1/2"	400	
061815	18 x LR 1/2"	160	
062215	22 x LR 1/2"	160	
062220	22 x LR 3/4"	160	
062525	25 x SR 1"	400	
062825	28 x LR 1"	160	
063532	35 x LR 1 1/4"	100	

JÄTKULIIDE



Tootekood	mm	PN	EN 1.4571
5106	6-L	250	
5108	8-L	250	
5110	10-L	250	
5112	12-L	250	
5115	15-L	250	
5116	16-S	400	
5118	18-L	160	
5122	22-L	160	
5125	25-S	400	
5128	28-L	160	

NURKLIIDE



Tootekood	mm	PN	EN 1.4571
6606	6-L	250	
6608	8-L	250	
6610	10-L	250	
6612	12-L	250	
6615	15-L	250	
6616	16-S	400	
6618	18-L	160	
6620	20-S	400	
6622	22-L	160	
6625	25-S	400	
6628	28-L	160	

NURKLÖPPLIIDE



Tootekood	mm/R	PN	EN 1.4571
360606	6 x LR 1/8"	250	
360608	6 x LR 1/4"	250	
360806	8 x LR 1/8"	250	
360808	8 x LR 1/4"	250	
361008	10 x LR 1/4"	250	
361010	10 x LR 3/8"	250	
361015	10 x LR 1/2"	250	
361208	12 x LR 1/4"	250	
361210	12 x LR 3/8"	250	
361215	12 x LR 1/2"	250	
361515	15 x LR 1/2"	250	
361615	16 x SR 1/2"	400	
361815	18 x LR 1/2"	160	
362020	20 x SR 3/4"	400	
362220	22 x LR 3/4"	160	

KOLMIKLIIDE



Tootekood	mm	PN	EN 1.4571
38106	6-L	250	
38108	8-L	250	
38110	10-L	250	
38112	12-L	250	
38115	15-L	250	
38116	16-S	400	
38118	18-L	160	
38122	22-L	160	
38125	25-S	400	
38128	28-L	160	

MUTTER



Tootekood	mm	PN	EN 1.4571
38206	6-L	250	
38208	8-L	250	
38210	10-L	250	
38212	12-L	250	
38215	15-L	250	
38216	16-S	400	
38218	18-L	160	
38222	22-L	160	
38225	25-S	400	
38228	28-L	160	

LÕIKERÕNGAS



Tootekood	mm	PN	EN 1.4571
38306	6-L	250	
38308	8-L	250	
38310	10-L	250	
38312	12-L	250	
38315	15-L	250	
38316	16-S	400	
38318	18-L	160	
38322	22-L	160	
38325	25-S	400	
38328	28-L	160	

HAPPEKINDLAD KEERMESTATUD TORUÜHENDUSED

MUHVID

POOLMUHV



Toote- kood	R	AISI 316
1201501	1/8"	
1201502	1/4"	
1201503	3/8"	
1201504	1/2"	
1201505	3/4"	
1201506	1"	
1201507	1 1/4"	
1201508	1 1/2"	
1201509	2"	
1201510	2 1/2"	
1201511	3"	
1201512	4"	

MUHV



Toote- kood	R	AISI 316
1201401	1/8"	
1201402	1/4"	
1201403	3/8"	
1201404	1/2"	
1201405	3/4"	
1201406	1"	
1201407	1 1/4"	
1201408	1 1/2"	
1201409	2"	
1201410	2 1/2"	
1201411	3"	
1201412	4"	
1201413	5"	

NIPLID

KEERME NIPPEL



Toote- kood	R	AISI 316
1203501	1/8"	
1203502	1/4"	
1203503	3/8"	
1203504	1/2"	
1203505	3/4"	
1203506	1"	
1203507	1 1/4"	
1203508	1 1/2"	
1203509	2"	
1203510	2 1/2"	
1203511	3"	
1203512	4"	

NIPPEL



Toote- kood	R	AISI 316
1203401	1/8"	
1203402	1/4"	
1203403	3/8"	
1203404	1/2"	
1203405	3/4"	
1203406	1"	
1203407	1 1/4"	
1203408	1 1/2"	
1203409	2"	
1203410	2 1/2"	
1203411	3"	
1203412	4"	
1203413	5"	
1203414	6"	

NIPLID

KAKSIKNIPPEL



Toote-kood	R	AISI 316
1201701	1/8"	
1201702	1/4"	
1201703	3/8"	
1201704	1/2"	
1201705	3/4"	
1201706	1"	
1201707	1 1/4"	
1201708	1 1/2"	
1201709	2"	
1201710	2 1/2"	
1201711	3"	

TORUNIPPEL



Toote-kood	R	AISI 316
1203301	1/8"	
1203302	1/4"	
1203303	3/8"	
1203304	1/2"	
1203305	3/4"	
1203306	1"	
1203307	1 1/4"	
1203308	1 1/2"	
1203309	2"	
1203310	2 1/2"	
1203311	3"	
1203312	4"	

KEEVITATAV KAKSIKNIPPEL



Toote-kood	R	AISI 316
1201802	1/4"	
1201803	3/8"	
1201804	1/2"	
1201805	3/4"	
1201806	1"	
1201807	1 1/4"	
1201808	1 1/2"	
1201809	2"	
1201810	2 1/2"	
1201811	3"	

KUUSKANT KORGID

SILINDERKEERE



Toote-kood	R	AISI 316
1202101	1/8"	
1202102	1/4"	
1202103	3/8"	
1202104	1/2"	
1202105	3/4"	
1202106	1"	
1202107	1 1/4"	
1202108	1 1/2"	
1202109	2"	
1202110	2 1/2"	
1202111	3"	

KOONUSKEERE



Toote-kood	R	AISI 316
1202001	1/8"	
1202002	1/4"	
1202003	3/8"	
1202004	1/2"	
1202005	3/4"	
1202006	1"	
1202007	1 1/4"	
1202008	1 1/2"	
1202009	2"	
1202010	2 1/2"	
1202011	3"	
1202012	4"	

NELIKANT KORK



Toote- kood	R	AISI 316
1201901	1/8"	
1201902	1/4"	
1201903	3/8"	
1201904	1/2"	
1201905	3/4"	
1201906	1"	
1201907	1 1/4"	
1201908	1 1/2"	
1201909	2"	
1201910	2 1/2"	
1201911	3"	
1201912	4"	

KUUSKANT KÜBAR



Toote- kood	R	AISI 316
1202301	1/8"	
1202302	1/4"	
1202303	3/8"	
1202304	1/2"	
1202305	3/4"	
1202306	1"	
1202307	1 1/4"	
1202308	1 1/2"	
1202309	2"	
1202310	2 1/2"	
1202311	3"	

NURK- ÜHENDUSED

SK/SK



Toote- kood	R	AISI 316
1200401	1/8"	
1200402	1/4"	
1200403	3/8"	
1200404	1/2"	
1200405	3/4"	
1200406	1"	
1200407	1 1/4"	
1200408	1 1/2"	
1200409	2"	
1200410	2 1/2"	
1200411	3"	
1200412	4"	

LUKUSTUS- MUTTER

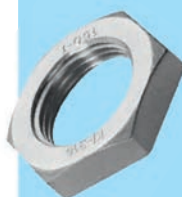

Toote- kood	R	AISI 316
1202601	1/8"	
1202602	1/4"	
1202603	3/8"	
1202604	1/2"	
1202605	3/4"	
1202606	1"	
1202607	1 1/4"	
1202608	1 1/2"	
1202609	2"	
1202610	2 1/2"	
1202611	3"	

SK/VK



Toote- kood	R	AISI 316
1200501	1/8"	
1200502	1/4"	
1200503	3/8"	
1200504	1/2"	
1200505	3/4"	
1200506	1"	
1200507	1 1/4"	
1200508	1 1/2"	
1200509	2"	

KOLMIKÜHENDUS



Toote-kood	R	AISI 316
1200801	1/8"	
1200802	1/4"	
1200803	3/8"	
1200804	1/2"	
1200805	3/4"	
1200806	1"	
1200807	1 1/4"	
1200808	1 1/2"	
1200809	2"	
1200810	2 1/2"	
1200811	3"	
1200812	4"	

RISTÜHENDUS



Toote-kood	R	AISI 316
1200301	1/8"	
1200302	1/4"	
1200303	3/8"	
1200304	1/2"	
1200305	3/4"	
1200306	1"	
1200307	1 1/4"	
1200308	1 1/2"	
1200309	2"	

LIITMIKUD TIHENDIGA



SK/SK

Toote-kood	R	AISI 316
1203201	1/8"	
1203202	1/4"	
1203203	3/8"	
1203204	1/2"	
1203205	3/4"	
1203206	1"	
1203207	1 1/4"	
1203208	1 1/2"	
1203209	2"	
1203210	2 1/2"	
1203211	3"	



SK/VK

Toote-kood	R	AISI 316
1203251	1/8"	
1203252	1/4"	
1203253	3/8"	
1203254	1/2"	
1203255	3/4"	
1203256	1"	
1203257	1 1/4"	
1203258	1 1/2"	
1203259	2"	
1203260	2 1/2"	
1203261	3"	



KEEVIS/VK

Toote-kood	mm/R	AISI 316
1203281	10,2 - 1/8"	
1203282	13,5 - 1/4"	
1203283	17,2 - 3/8"	
1203284	21,3 - 1/2"	
1203285	26,9 - 3/4"	
1203286	33,7 - 1"	
1203287	42,4 - 1 1/4"	
1203288	48,3 - 1 1/2"	
1203289	60,3 - 2"	

KOONUSLIITMIKUD

SK/SK



Toote-kood	R	AISI 316
1202901	1/8"	
1202902	1/4"	
1202903	3/8"	
1202904	1/2"	
1202905	3/4"	
1202906	1"	
1202907	1 1/4"	
1202908	1 1/2"	
1202909	2"	
1202910	2 1/2"	
1202911	3"	
1202912	4"	

SK/VK



Toote-kood	R	AISI 316
1203001	1/8"	
1203002	1/4"	
1203003	3/8"	
1203004	1/2"	
1203005	3/4"	
1203006	1"	
1203007	1 1/4"	
1203008	1 1/2"	
1203009	2"	
1203010	2 1/2"	
1203011	3"	

KEEVIS/KEEVIS



Toote-kood	DN/mm	AISI 316
1203101	DN6/10,2	
1203102	DN8/13,5	
1203103	DN10/17,2	
1203104	DN15/21,3	
1203105	DN20/26,9	
1203106	DN25/33,7	
1203107	DN32/42,4	
1203108	DN40/48,3	
1203109	DN50/60,3	
1203110	DN65/76,1	
1203111	DN80/88,9	

KEEVIS/SK



Toote-kood	mm/R	AISI 316
1203151	10,2 - 1/8"	
1203152	13,5 - 1/4"	
1203153	17,2 - 3/8"	
1203154	21,3 - 1/2"	
1203155	26,9 - 3/4"	
1203156	33,7 - 1"	
1203157	42,4 - 1 1/4"	
1203158	48,3 - 1 1/2"	
1203159	60,3 - 2"	

KEEVIS/VK



Toote-kood	mm/R	AISI 316
1203173	17,2 - 3/8"	
1203174	21,3 - 1/2"	
1203175	26,9 - 3/4"	
1203176	33,7 - 1"	
1203177	42,4 - 1 1/4"	
1203178	48,3 - 1 1/2"	
1203179	60,3 - 2"	

ÜLEMINEKUNIPPEL



Toote- kood	R	AISI 316
1201101	1/4 x 1/8"	
1201102	3/8 x 1/8"	
1201103	3/8 x 1/4"	
1201104	1/2 x 1/8"	
1201105	1/2 x 1/4"	
1201106	1/2 x 3/8"	
1201107	3/4 x 1/4"	
1201108	3/4 x 3/8"	
1201109	3/4 x 1/2"	
1201110	1 x 1/4"	
1201111	1 x 3/8"	
1201112	1 x 1/2"	
1201113	1 x 3/4"	
1201114	1 1/4 x 3/8"	
1201115	1 1/4 x 1/2"	

Toote- kood	R	AISI 316
1201116	1 1/4 x 3/4"	
1201117	1 1/4 x 1"	
1201118	1 1/2 x 1/2"	
1201120	1 1/2 x 3/4"	
1201121	1 1/2 x 1"	
1201122	1 1/2 x 1 1/4"	
1201123	2 x 1/2"	
1201124	2 x 3/4"	
1201125	2 x 1"	
1201126	2 x 1 1/4"	
1201127	2 x 1 1/2"	
1201130	2 1/2 x 1 1/2"	
1201131	2 1/2 x 2"	
1201134	3 x 2"	
1201137	3 x 2 1/2"	
1201139	4 - 3"	

ÜLEMINEKUKAKSIKNIPPEL



Toote- kood	R	AISI 316
1201201	1/4 x 1/8"	
1201202	3/8 x 1/8"	
1201203	3/8 x 1/4"	
1201204	1/2 x 1/8"	
1201205	1/2 x 1/4"	
1201206	1/2 x 3/8"	
1201207	3/4 x 1/4"	
1201208	3/4 x 3/8"	
1201209	3/4 x 1/2"	
1201211	1 x 3/8"	
1201212	1 x 1/2"	
1201213	1 x 3/4"	
1201215	1 1/4 x 1/2"	

Toote- kood	R	AISI 316
1201216	1 1/4 x 3/4"	
1201217	1 1/4 x 1"	
1201219	1 1/2 x 1/2"	
1201220	1 1/2 x 3/4"	
1201221	1 1/2 x 1"	
1201222	1 1/2 x 1 1/4"	
1201228	2 x 1"	
1201229	2 x 1 1/4"	
1201230	2 x 1 1/2"	
1201236	2 1/2 x 1 1/2"	
1201238	2 1/2 x 2"	
1201240	3 x 2"	
1201242	3 x 2 1/2"	

KAAR



Toote- kood	R	AISI 316
1200201	1/8"	
1200202	1/4"	
1200203	3/8"	
1200204	1/2"	

Toote- kood	R	AISI 316
1200205	3/4"	
1200206	1"	
1200207	1 1/4"	
1200208	1 1/2"	
1200209	2"	

ÜLEMINEKUMUHV



Toote-koode	R	AISI 316
1201001	1/4 x 1/8"	
1201002	3/8 x 1/8"	
1201003	3/8 x 1/4"	
1201004	1/2 x 1/8"	
1201005	1/2 x 1/4"	
1201006	1/2 x 3/8"	
1201007	3/4 x 1/4"	
1201008	3/4 x 3/8"	
1201009	3/4 x 1/2"	
1201010	1 x 1/4"	
1201011	1 x 3/8"	
1201012	1 x 1/2"	
1201013	1 x 3/4"	
1201015	1 1/4 x 1/2"	

Toote-koode	R	AISI 316
1201016	1 1/4 x 3/4"	
1201017	1 1/4 x 1"	
1201020	1 1/2 x 1/2"	
1201021	1 1/2 x 3/4"	
1201022	1 1/2 x 1"	
1201023	1 1/2 x 1 1/4"	
1201024	2 x 1/2"	
1201025	2 x 1"	
1201026	2 x 1 1/4"	
1201027	2 x 1 1/2"	
1201030	2 1/2 x 1 1/2"	
1201031	2 1/2 x 2"	
1201035	3 x 2"	
1201036	3 x 2 1/2"	

KÜÜSLITMIKUD

VOOLIKUOTS, EPDM



Toote-koode	Suurus	AISI 316
723010	45 x 10	
723013	45 x 13	
723020	45 x 20	
723025	45 x 25	
723032	75 x 32	
723040	75 x 40	
723050	75 x 50	

SISEKEERE, EPDM



Toote-koode	Suurus	AISI 316
721010	45 x 3/8"	
721015	45 x 1/2"	
721020	45 x 3/4"	
721025	45 x 1"	
721032	75 x 1 1/4"	
721040	75 x 1 1/2"	
721050	75 x 2"	

VÄLISKEERE, EPDM



Toote-koode	Suurus	AISI 316
722010	45 x 3/8"	
722015	45 x 1/2"	
722020	45 x 3/4"	
722025	45 x 1"	
722032	75 x 1 1/4"	
722040	75 x 1 1/2"	
722050	75 x 2"	

NOOKURLITMIKUD

A: ISANE SISEKEERMEGA



Toote-kood	R	AISI 316
71015A	1/2"	
71020A	3/4"	
71025A	1"	
71032A	1 1/4"	
71040A	1 1/2"	
71050A	2"	
71065A	2 1/2"	
71080A	3"	
71100A	4"	

F: ISANE VÄLISKEERMEGA



Toote-kood	R	AISI 316
74015F	1/2"	
74020F	3/4"	
74025F	1"	
74032F	1 1/4"	
74040F	1 1/2"	
74050F	2"	
74065F	2 1/2"	
74080F	3"	
74100F	4"	

B: EMANE VÄLISKEERMEGA EPDM



Toote-kood	R	AISI 316
72015B	1/2"	
72020B	3/4"	
72025B	1"	
72032B	1 1/4"	
72040B	1 1/2"	
72050B	2"	
72065B	2 1/2"	
72080B	3"	
72100B	4"	

D: EMANE SISEKEERMEGA EPDM



Toote-kood	R	AISI 316
73015D	1/2"	
73020D	3/4"	
73025D	1"	
73032D	1 1/4"	
73040D	1 1/2"	
73050D	2"	
73065D	2 1/2"	
73080D	3"	
73100D	4"	

DC: TURVAKÜBAR



Toote-kood	R	AISI 316
75015DC	1/2"	
75020DC	3/4"	
75025DC	1"	
75032DC	1 1/4"	
75040DC	1 1/2"	
75050DC	2"	
75065DC	2 1/2"	
75080DC	3"	
75100DC	4"	

DP: TURVAKORK



Toote-kood	R	AISI 316
76015DP	1/2"	
76020DP	3/4"	
76025DP	1"	
76032DP	1 1/4"	
76040DP	1 1/2"	
76050DP	2"	
76065DP	2 1/2"	
76080DP	3"	
76100DP	4"	

VOOLIKUOTSAD



Toote-kood	R/vooliku mõõt	AISI 316
1203981	1/8" x 10,2	
1203982	1/4" x 13,5	
1203983	3/8" x 17,2	
1203984	1/2" x 21,3	
1203985	3/4" x 26,9	
1203986	1" x 33,7	
1203987	1 1/4" x 42,4	
1203988	1 1/2" x 48,3	
1203989	2" x 60,3	
1203990	2 1/2" x 76,1	
1203991	3" x 88,9	



Toote-kood	R/vooliku mõõt	AISI 316
1203901	1/8" x 6	
1203902	1/8" x 8	
1203903	1/8" x 10	
1203905	1/4" x 6	
1203907	1/4" x 8	
12039079	1/4" x 9	
1203908	1/4" x 10	
1203909	1/4" x 12	
1203910	3/8" x 10	
1203911	3/8" x 11	
1203913	3/8" x 13	
1203914	3/8" x 16	
1203915	1/2" x 10	
1203916	1/2" x 13	
1203917	1/2" x 16	
1203919	1/2" x 19	
1203921	3/4" x 20	
1203925	3/4" x 25	
1203926	1" x 25	
1203930	1" x 32	
1203932	1 1/4" x 32	
1203940	1 1/2" x 40	
1203950	2" x 50	
1203963	2 1/2" x 63	
1203975	3" x 75	

KEEVITATAV



Toote-kood	DN/vooliku mõõt	AISI 316
1204001	DN6 x 10,2	
1204002	DN8 x 13,5	
1204003	DN10 x 17,2	
1204004	DN15 x 21,3	
1204005	DN20 x 26,9	
1204006	DN25 x 33,7	
1204007	DN32 x 42,4	
1204008	DN40 x 48,3	
1204009	DN50 x 60,3	

VOOLIKUPINGUTAJA



Toote-kood	Pingutus (mm)	AISI 316
1206014	10-14	
1206017	12-17	
1206020	17-20	
1206024	18-24	
1206028	22-28	
1206032	25-32	
1206038	26-38	
1206044	32-44	
1206050	38-50	

Toote-kood	Pingutus (mm)	AISI 316
1206056	44-56	
1206065	50-65	
1206075	58-75	
1206085	68-85	
1206095	77-95	
1206112	87-112	
1206138	104-138	
1206165	130-165	
1206180	155-180	

ROOSTEVABA TERASE

VÕRDLUSTABELID

EN	ASTM	UNI	SFS	SS	NF	BS
1.4301	304	X5 CrNi 18 10	725	2333	Z6CN 18-9	304 S 15
1.4305	303	X10 CrNiS 18 9	—	2346	Z10CNF 18-9	303 S 21
1.4306	304L	X2 CrNi 18 11	720	2352	Z3CN 18-11	304 S 12
1.4541	321	X6 CrNiTi 18 11	731	2337	Z6CNT 18-11	321 S 12
1.4401	316	X5 CrNiMo 17 12	755	2343	Z6CND 17-11	316 S 16
1.4404	316L	X2 CrNiMo 17 12	750	2348	Z2CND 17-12	316 S 12
1.4435	316L	X2 CrNiMo 17 13	752	2353	Z2CND 17-13	316 S 12
1.4436	316	X8 CrNiMo 17 13	757	2343	Z6CND 17-12	316 S 16
1.4571	316Ti	X6 CrNiMoTi 17 12	761	2350	Z8CNDT 17-12	320 S 17
1.4460	329	—	—	2324	Z5CND 27-5 AZ	—
1.4539	904L	—	775	2562	Z1NCDU 25-20	—
1.4547	S31254	—	778	2378	—	—
1.4828	309	X16 CrNiSi 20 12	—	—	Z15CNS 20-12	309 S 24

DN sisemõõt	DN välismõõt	R	ANSI	DN sisemõõt	DN välismõõt	R	ANSI
6	10,2 mm	1/8"	10,20 mm	50	60,3 mm	2"	60,33 mm
8	13,5 mm	1/4"	13,72 mm	65	76,1 mm	2 1/2"	73,03 mm
10	17,2 mm	3/8"	17,15 mm	80	88,9 mm	3"	88,90 mm
15	21,3 mm	1/2"	21,34 mm	100	114,3 mm	4"	114,30 mm
20	26,9 mm	3/4"	26,67 mm	125	139,7 mm	5"	141,30 mm
25	33,7 mm	1"	33,40 mm	150	168,3 mm	6"	168,28 mm
32	42,4 mm	1 1/4"	42,16 mm	200	219,1 mm	8"	219,08 mm
40	48,3 mm	1 1/2"	48,26 mm	250	273,0 mm	10"	273,05 mm
				300	323,9 mm	12"	323,85 mm

DN sisemõõt = sisemõõt
 DN Isonorm = välismõõt
 Näiteks 1" = 25 mm = 33,7 mm

EN	C max.%	CR %	NI %	MN max.%	SI max.%	S max.%	MO %	TI min.%
1.4301	0,07	17,0-19,0	8,5-10,5	2,0	1,0	0,030	—	—
1.4305	0,12	17,0-19,0	8,0-10,0	2,0	1,0	0,350	—	—
1.4306	0,03	18,0-20,0	10,0-12,5	2,0	1,0	0,030	—	—
1.4541	0,08	17,0-19,0	9,0-12,0	2,0	1,0	0,030	—	5 x %C
1.4401	0,07	16,5-18,5	10,5-13,5	2,0	1,0	0,030	2,0-2,5	—
1.4404	0,03	16,5-18,5	11,0-14,0	2,0	1,0	0,030	2,0-2,5	—
1.4435	0,03	17,0-18,5	12,5-15,0	2,0	1,0	0,025	2,5-3,0	—
1.4436	0,07	16,5-18,5	11,0-14,0	2,0	1,0	0,025	2,5-3,0	—
1.4571	0,08	16,5-18,5	10,5-13,5	2,0	1,0	0,030	2,0-2,5	5 x %C
1.4460	0,10	24,0-27,0	4,5-6,0	2,0	1,0	0,030	1,3-1,8	—
1.4539	0,02	19,0-21,0	24,0-26,0	2,0	0,7	0,015	4,0-5,0	—
1.4547	0,02	19,5-20,5	17,5-18,5	1,0	0,8	0,010	6,0-6,5	—
1.4828	0,02	19,0-21,0	11,0-13,0	2,0	2,3	0,300	—	—

Ava mm	Samm mm	Laius x pikkus x paksus mm	Tüüm no	Avatud pind	Kaal kg / tk
R 0,5	T 1,09	1000 X 2000 X 0,5	705-020	19%	6,5
R 1,0	T 2,0	1000 X 2000 X 0,5	710-000	23%	6,2
R 1,0	T 2,0	1000 X 2000 X 0,75	710-000	23%	9,3
R 1,0	T 2,0	1000 X 2000 X 1,0	710-000	23%	12,4
R 1,25	T 2,4	1000 X 2000 X 0,75	712-008	25%	9,1
R 1,25	T 2,4	1000 X 2000 X 1,0	712-008	25%	12,1
R 1,5	T 2,6	1000 X 2000 X 0,75	715-000	30%	8,4
R 1,5	T 2,6	1000 X 2000 X 1,0	715-000	30%	11,2
R 1,5	T 3,0	1000 X 2000 X 1,5	715-001	23%	18,7
R 1,75	T 3,0	1000 X 2000 X 1,0	717-001	31%	11,1
R 1,75	T 3,0	1000 X 2000 X 1,5	717-001	31%	16,7
R 2,0	T 3,5	1000 X 2000 X 0,5	720-000	30%	5,7
R 2,0	T 3,5	1000 X 2000 X 0,75	720-000	30%	8,5
R 2,0	T 3,5	1000 X 2000 X 1,0	720-000	30%	11,3
R 2,0	T 3,5	1000 X 2000 X 1,5	720-000	30%	17,0
R 2,0	T 3,5	1000 X 2000 X 2,0	720-000	30%	22,7
R 2,0	T 3,5	1250 X 2500 X 2,0	720-000	30%	35,0
R 2,0	T 3,5	1500 X 3000 X 2,0	720-000	30%	50,4
R 2,0	T 4,0	1000 X 2000 X 1,0	720-001	23%	12,3
R 2,5	T 4,0	1000 X 2000 X 1,0	725-002	36%	10,4
R 2,5	T 4,0	1000 X 2000 X 1,5	725-002	36%	15,6
R 2,5	T 4,0	1000 X 2000 X 2,0	725-002	36%	20,8
R 2,5	T 4,0	1500 X 3000 X 2,5	725-002	36%	57,6
R 2,5	T 4,5	1000 X 2000 X 2,5	725-000	28%	28,8
R 2,75	T 4,5	1000 X 2000 X 2,0	727-001	34%	21,3
R 2,75	T 4,5	1500 X 3000 X 2,5	727-001	34%	59,4
R 3,0	T 4,0	1000 X 2000 X 3,0	730-006	51%	24,0
R 3,0	T 4,0	1500 X 3000 X 3,0	730-006	51%	52,9
R 3,0	T 4,5	1500 X 3000 X 3,0	730-030	40%	64,5
R 3,0	T 5,0	1000 X 2000 X 0,75	730-000	33%	8,0
R 3,0	T 5,0	1000 X 2000 X 1,0	730-000	33%	10,9
R 3,0	T 5,0	1250 X 2500 X 1,0	730-000	33%	17,0
R 3,0	T 5,0	1000 X 2000 X 1,5	730-000	33%	16,3
R 3,0	T 5,0	1000 X 2000 X 2,0	730-000	33%	21,7
R 3,0	T 5,0	1000 X 2000 X 3,0	730-000	33%	32,6
R 3,0	T 5,0	1250 X 2500 X 3,0	730-000	33%	50,2
R 3,5	T 5,0	1000 X 2000 X 1,0	735-001	44%	9,0
R 3,5	T 5,5	1000 X 2000 X 2,0	735-000	37%	20,5
R 3,5	T 5,5	1000 X 2000 X 3,0	735-000	37%	30,7
R 3,5	T 5,5	1500 X 3000 X 3,0	735-000	37%	68,0
R 4,0	T 5,5	1000 X 2000 X 1,0	740-000	46%	8,7
R 4,0	T 6,0	1000 X 2000 X 1,0	740-020	40%	9,6
R 4,0	T 6,0	1000 X 2000 X 1,5	740-020	40%	14,5
R 4,0	T 6,0	1000 X 2000 X 2,0	740-020	40%	19,3
R 4,0	T 6,0	1000 X 2000 X 3,0	740-020	40%	29,0
R 4,0	T 6,0	1250 X 2500 X 3,0	740-020	40%	45,0
R 4,0	T 6,0	1500 X 3000 X 3,0	740-020	40%	64,8
R 4,0	T 6,0	1000 X 2000 X 4,0	740-020	40%	38,4
R 4,0	T 6,0	1500 X 3000 X 4,0	740-020	40%	86,5

R = ümar, C = nelinurk, LR = pilu, T = kolmjagu, U = nelijagu

705-020

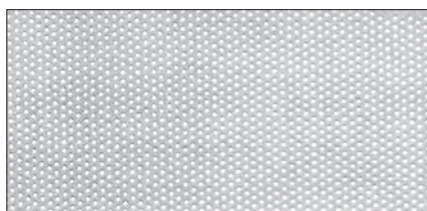

710-000

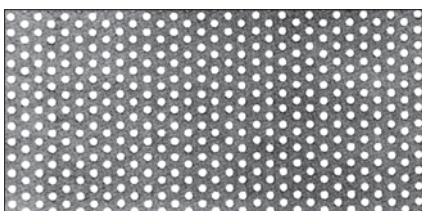

712-008

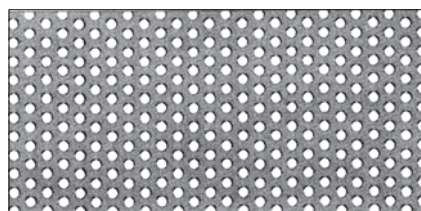

715-000

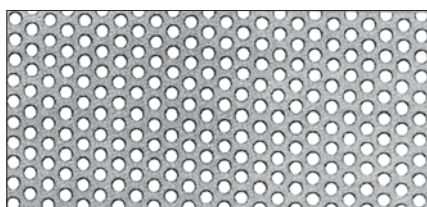

715-001

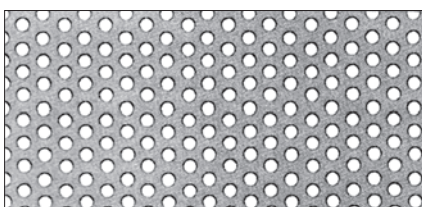

717-001

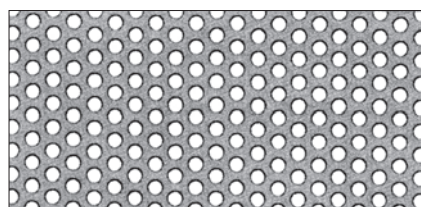

720-000

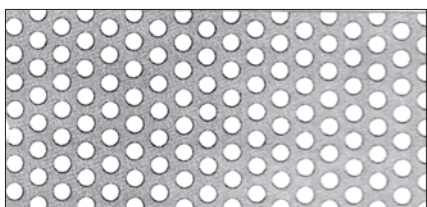

720-001

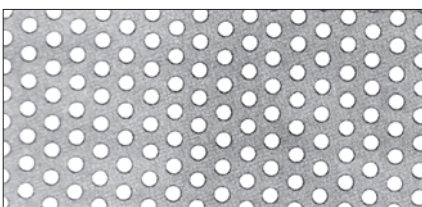

725-002

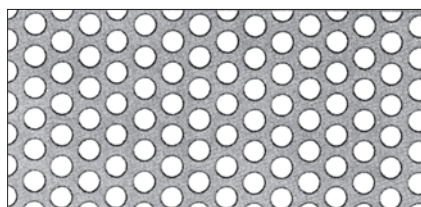

725-000

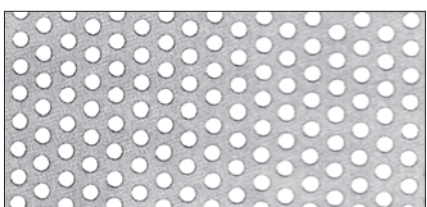

727-001

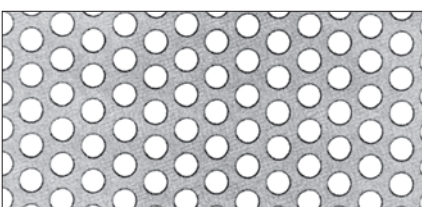

730-006

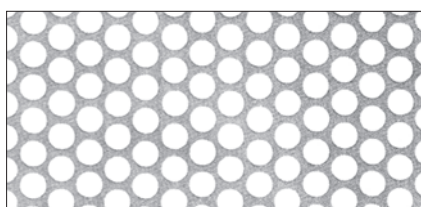

730-030

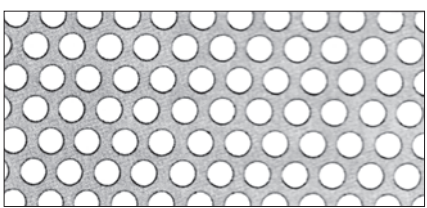

730-000

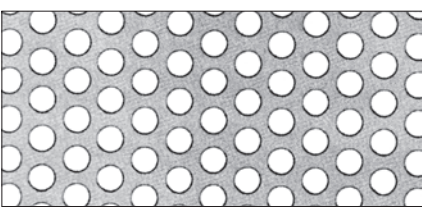

735-001

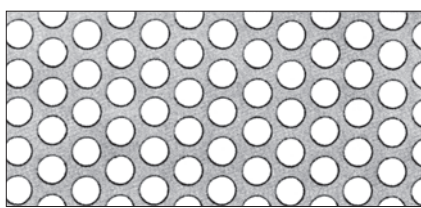

735-000

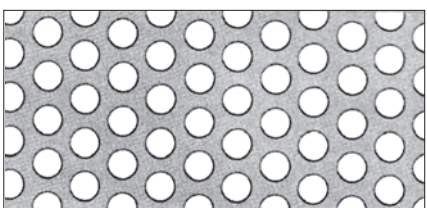

740-000

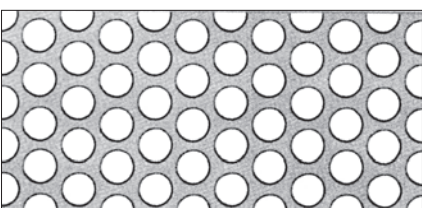

740-020

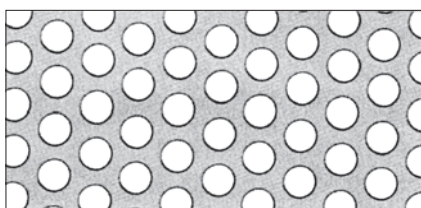

TERAS

TERAS ÜMARA AVAGA

Ava mm	Samm mm	Laius x pikkus x paksus mm	Tüüm no	Avatud pind	Kaal kg / tk
R 4,5	T 7,0	1000 X 2000 X 2,0	745-000	38%	20,2
R 4,5	U 15,0 X 15,0	1000 X 2000 X 1,5	745-008	7%	22,3
R 5,0	T 6,5	1000 X 2000 X 1,0	750-021	56%	7,0
R 5,0	T 7,5	1000 X 2000 X 0,7	750-000	40%	6,7
R 5,0	T 7,5	1000 X 2000 X 1,0	750-000	40%	9,6
R 5,0	T 7,5	1000 X 2000 X 1,5	750-000	40%	14,5
R 5,0	T 7,5	1250 X 2500 X 1,5	750-000	40%	22,6
R 5,0	T 7,5	1250 X 2500 X 3,0	750-000	40%	45,0
R 5,0	T 7,5	1500 X 3000 X 3,0	750-000	40%	64,8
R 5,0	T 8,0	1000 X 2000 X 1,0	750-002	35%	10,4
R 5,0	T 8,0	1250 X 2500 X 1,0	750-002	35%	16,3
R 5,0	T 8,0	1000 X 2000 X 1,5	750-002	35%	15,6
R 5,0	T 8,0	1250 X 2500 X 1,5	750-002	35%	24,4
R 5,0	T 8,0	1000 X 2000 X 2,0	750-002	35%	20,8
R 5,0	T 8,0	1000 X 2000 X 3,0	750-002	35%	31,3
R 5,0	T 8,0	1000 X 2000 X 4,0	750-002	35%	41,6
R 5,0	T 8,0	1000 X 2000 X 5,0	750-002	35%	52,0
R 5,0	U 10,0 X 10,0	1000 X 2000 X 1,0	750-003	20%	12,8
R 5,0	U 12,5 X 12,5	1000 X 2000 X 1,5	750-019	13%	21,1
R 6,0	T 8,0	1000 X 2000 X 1,0	760-000	51%	8,1
R 6,0	T 8,0	1000 X 2000 X 1,5	760-000	51%	12,1
R 6,0	T 8,0	1250 X 2500 X 1,5	760-000	51%	18,4
R 6,0	T 9,0	1000 X 2000 X 2,0	760-020	40%	19,5
R 6,0	T 9,0	1000 X 2000 X 3,0	760-020	40%	29,2
R 6,0	T 9,0	1250 X 2500 X 3,0	760-020	40%	45,0
R 6,0	T 9,0	1500 X 3000 X 3,0	760-020	40%	64,8
R 6,0	T 9,0	1000 X 2000 X 4,0	760-020	40%	38,4
R 6,0	T 9,0	1000 X 2000 X 5,0	760-020	40%	48,0
R 6,0	T 9,0	1500 X 3000 X 5,0	760-020	40%	108,0
R 6,0	T 9,0	1000 X 2000 X 6,0	760-020	40%	57,6
R 7,0	T 10,0	1000 X 2000 X 1,0	770-000	44%	9,6
R 8,0	T 10,0	1000 X 2000 X 1,0	780-000	58%	6,9
R 8,0	T 10,0	1000 X 2000 X 1,5	780-000	58%	10,4
R 8,0	T 11,0	1000 X 2000 X 2,0	780-020	48%	17,1
R 8,0	T 11,0	1000 X 2000 X 3,0	780-020	48%	25,6
R 8,0	T 12,0	1000 X 2000 X 1,0	780-001	40%	9,6
R 8,0	T 12,0	1000 X 2000 X 1,5	780-001	40%	14,4
R 8,0	T 12,0	1000 X 2000 X 2,0	780-001	40%	19,2
R 8,0	T 12,0	1250 X 2500 X 3,0	780-001	40%	45,0
R 8,0	T 12,0	1500 X 3000 X 3,0	780-001	40%	64,8
R 8,0	T 12,0	1000 X 2000 X 4,0	780-001	40%	38,4
R 8,0	T 12,0	1000 X 2000 X 5,0	780-001	40%	48,0
R 8,0	T 12,0	1500 X 3000 X 5,0	780-001	40%	108,0
R 8,0	T 12,0	1000 X 2000 X 6,0	780-001	40%	57,6
R 8,0	T 15,0	1000 X 2000 X 8,0	780-028	26%	94,7
R 9,0	T 12,0	1000 X 2000 X 2,0	790-000	51%	15,7
R 10,0	T 12,7	1000 X 2000 X 1,0	810-000	56%	7,2
R 10,0	T 12,7	1000 X 2000 X 1,5	810-000	56%	10,7
R 10,0	T 12,7	1000 X 2000 X 2,0	810-000	56%	14,3
R 10,0	T 14,0	1000 X 2000 X 1,0	810-044	46%	8,6

R = ümar, C = nelinurk, LR = pilu, T = kolmjagu, U = nelijagu

745-000

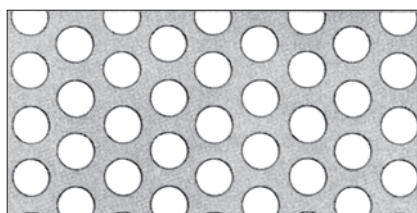

745-008

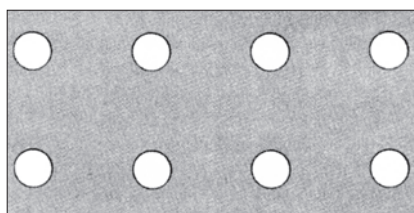

750-021

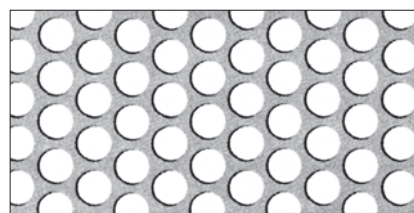

750-000

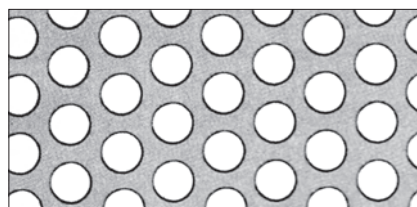

750-002

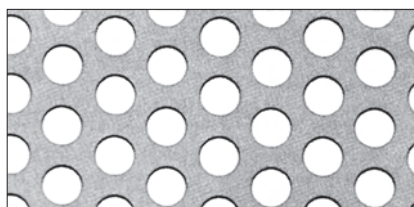

750-003

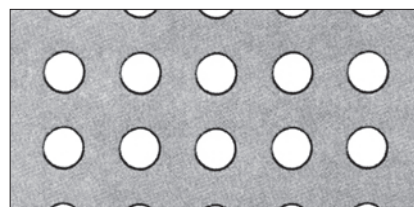

750-019

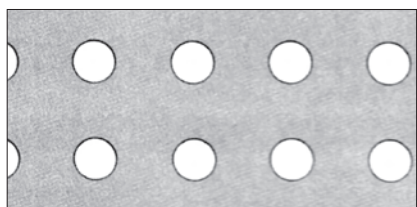

760-000

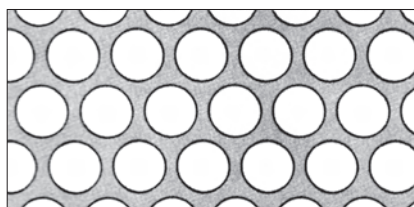

760-020

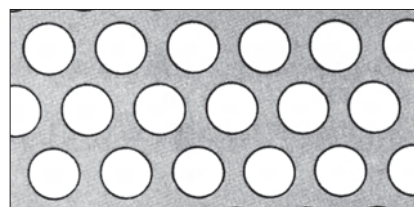

770-000

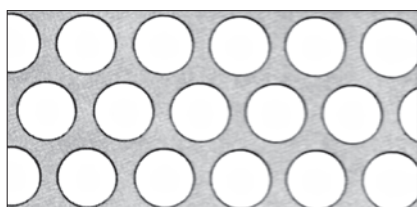

780-000

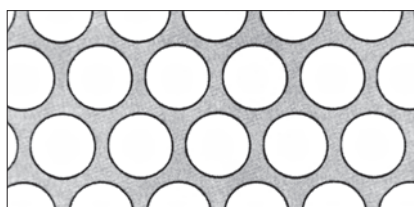

780-020

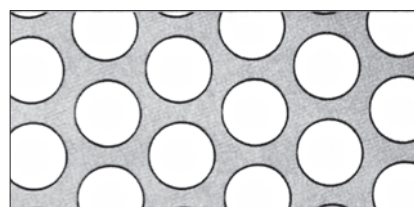

780-001

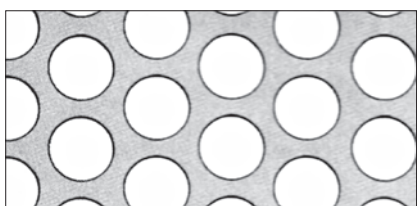

780-028

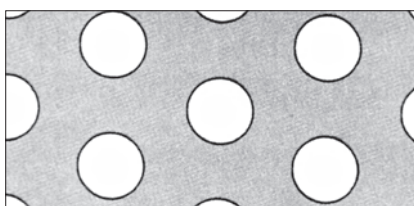

790-000

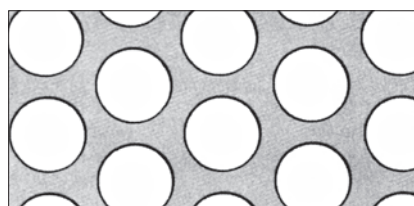

810-000

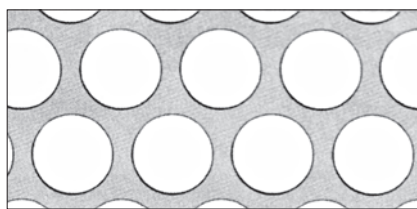

810-044

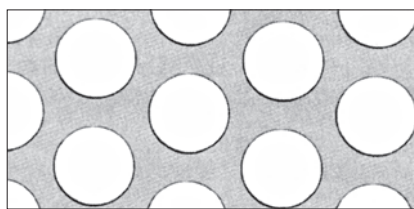

TERAS ÜMARA AVAGA

Ava mm	Samm mm	Laius x pikkus x paksus mm	Tüüm no	Avatud pind	Kaal kg / tk
R 10,0	T 15,0	1000 X 2000 X 1,5	810-003	40%	14,4
R 10,0	T 15,0	1000 X 2000 X 3,0	810-003	40%	29,1
R 10,0	T 15,0	1250 X 2500 X 3,0	810-003	40%	45,8
R 10,0	T 15,0	1500 X 3000 X 3,0	810-003	40%	64,8
R 10,0	T 15,0	1000 X 2000 X 4,0	810-003	40%	38,4
R 10,0	T 15,0	1000 X 2000 X 5,0	810-003	40%	48,0
R 10,0	T 15,0	1500 X 3000 X 5,0	810-003	40%	108,0
R 10,0	T 15,0	1000 X 2000 X 6,0	810-003	40%	57,6
R 10,0	T 16,0	1000 X 2000 X 8,0	810-001	35%	83,2
R 10,0	T 16,0	1250 X 2500 X 8,0	810-001	35%	130,0
R 10,0	T 16,0	1000 X 2000 X 10,0	810-001	35%	104,0
R 11,0	T 14,5	1000 X 2000 X 1,0	811-000	52%	7,5
R 12,0	T 15,55	1000 X 2000 X 1,0	812-013	54%	7,6
R 12,0	T 15,55	1000 X 2000 X 2,0	812-013	54%	15,3
R 12,0	T 16,0	1000 X 2000 X 1,0	812-000	51%	7,8
R 12,0	T 16,0	1000 X 2000 X 3,0	812-000	51%	23,5
R 12,0	T 16,0	1250 X 2500 X 3,0	812-000	51%	36,8
R 12,0	T 16,0	1000 X 2000 X 6,0	812-000	51%	47,0
R 12,0	T 16,0	1250 X 2500 X 6,0	812-000	51%	73,5
R 12,0	T 18,0	1000 X 2000 X 8,0	812-001	40%	76,8
R 12,0	T 18,0	1000 X 2000 X 12,0	812-001	40%	115,2
R 14,0	T 16,5	1000 X 2000 X 1,0	814-000	65%	5,5
R 15,0	T 20,0	1000 X 2000 X 1,0	815-006	51%	8,0
R 15,0	T 20,0	1000 X 2000 X 2,0	815-006	51%	16,1
R 15,0	T 20,0	1000 X 2000 X 3,0	815-006	51%	24,1
R 15,0	T 21,0	1500 X 3000 X 3,0	815-000	46%	58,3
R 15,0	T 21,0	1000 X 2000 X 4,0	815-000	46%	34,6
R 15,0	T 21,0	1000 X 2000 X 5,0	815-000	46%	43,2
R 15,0	T 24,7	1000 X 2000 X 10,0	815-005	33%	107,2
R 15,0	T 30,0	1000 X 2000 X 12,0	815-011	23%	147,8
R 16,0	T 20,0	1000 X 2000 X 1,0	816-000	58%	7,0
R 20,0	T 28,0	1000 X 2000 X 1,0	816-000	58%	8,8
R 20,0	T 28,0	1000 X 2000 X 3,0	820-002	46%	26,3
R 20,0	T 28,0	1000 X 2000 X 4,0	820-002	46%	34,6
R 25,0	T 28,0	1000 X 2000 X 5,0	820-002	46%	43,2
R 25,0	T 39,0	1000 X 2000 X 1,0	825-001	37%	10,1

TERAS NELIKANT AVAGA JA ERITÜÜBID

Ava mm	Samm mm	Laius x pikkus x paksus mm	Tüüm no	Avatud pind	Kaal kg / tk
C 4,0	U 6,38 X 6,38	1000 X 2000 X 1,0	404-000	39%	9,8
C 5,0	U 7,5 X 7,5	1000 X 2000 X 1,0	405-000	44%	9,0
C 5,0	U 7,5 X 7,5	1000 X 2000 X 1,5	405-000	44%	13,5
C 6,0	U 10,0 X 10,0	1000 X 2000 X 1,0	406-000	36%	10,5
C 8,0	U 10,0 X 10,0	1000 X 2000 X 1,0	408-005	64%	5,9
C 8,0	U 10,0 X 10,0	1000 X 2000 X 1,5	408-005	64%	8,6
C 8,0	U 11,0 X 11,0	1000 X 2000 X 1,0	408-013	53%	7,7
C 8,0	U 12,0 X 12,0	1000 X 2000 X 1,5	408-004	44%	13,6
C 9,0	U 34,0 X 34,0	1000 X 2000 X 1,5	409-005	7%	22,3
C 9,0	U 34,0 X 34,0	1250 X 2500 X 1,5	409-005	7%	34,9

R = ümar, C = nelinurk, LR = pilu, T = kolmjagu, U = nelijagu

810-003

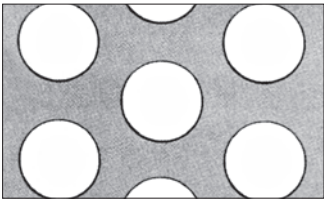

810-001

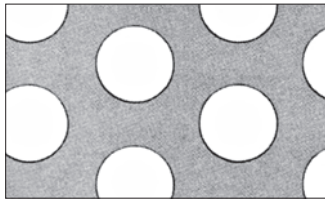

811-000

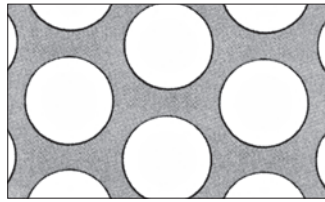

812-013

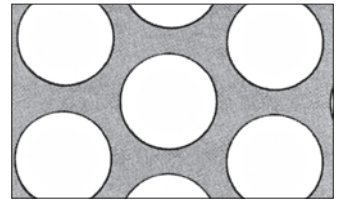

812-000

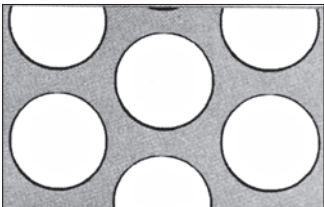

812-001

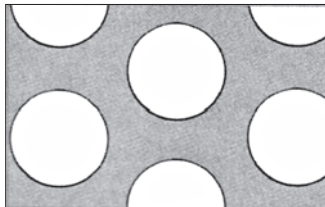

814-000

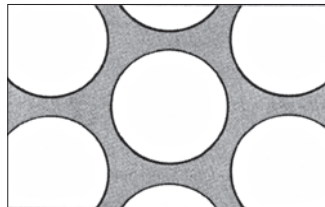

815-006

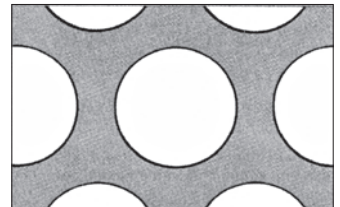

815-000

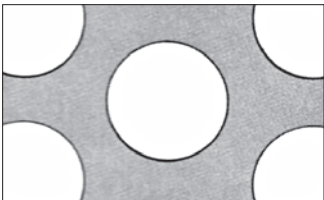

815-005



815-011

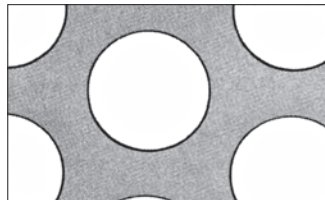

816-000

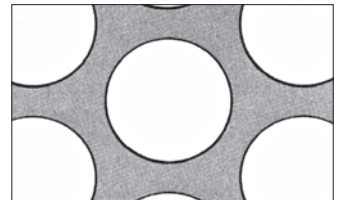

820-002

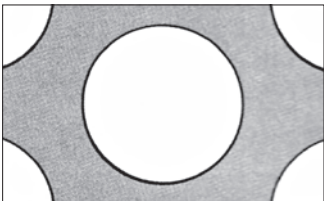

825-001



404-000

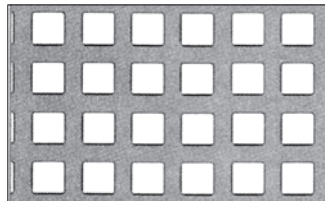

405-000

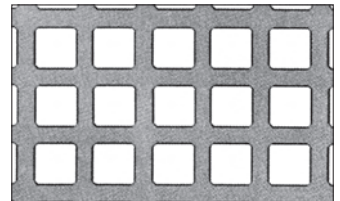

406-000

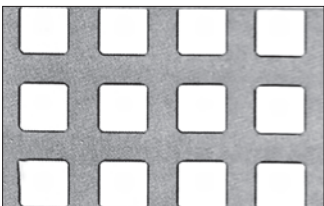

408-005

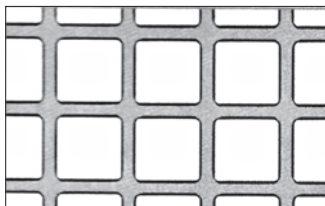

408-013

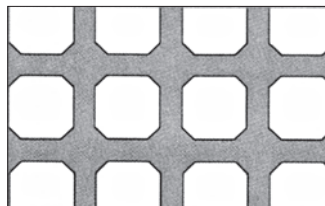

408-004

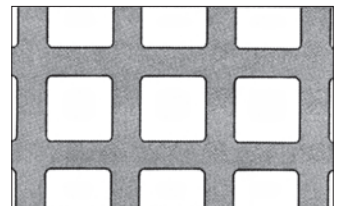

409-005

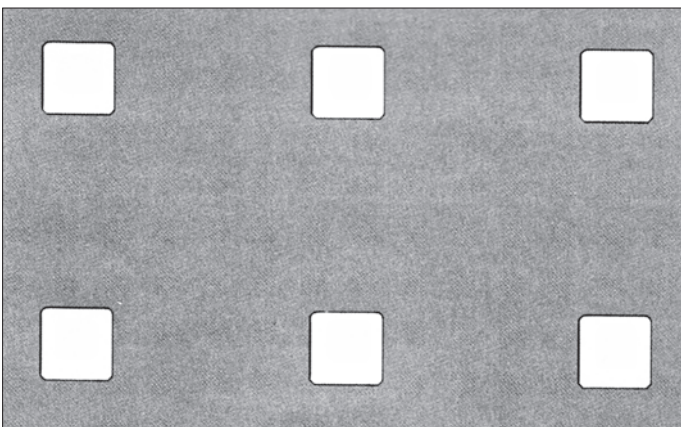

TERAS NELIKANT AVAGA JA ERITÜÜBID

Ava mm	Samm mm	Laius x pikkus x paksus mm	Tüüm no	Avatud pind	Kaal kg / tk
C 9,2	U 38,0 X 38,0	1000 X 2000 X 1,5	409-012	6%	22,6
C 9,5	U 13,33 X 13,33	1000 X 2000 X 1,0	409-013	51%	8,1
C 9,5	U 13,33 X 13,33	1250 X 2500 X 1,0	409-013	51%	12,4
C 9,5	U 13,33 X 13,33	1000 X 2000 X 1,5	409-013	51%	12,1
C 9,5	U 13,33 X 13,33	1250 X 2500 X 1,5	409-013	51%	19,0
C 9,5	U 13,33 X 13,33	1000 X 2000 X 2,0	409-013	51%	16,2
C 9,5	U 13,33 X 13,33	1250 X 2500 X 2,0	409-013	51%	25,3
C 9,5	U 13,33 X 13,33	1000 X 2000 X 3,0	409-013	51%	24,3
C 9,5	U 13,33 X 13,33	1250 X 2500 X 3,0	409-013	51%	38,9
C 9,5	U 13,33 X 13,33	1500 X 3000 X 3,0	409-013	51%	52,9
C 10,0	U 12,0 X 12,0	1000 X 2000 X 1,0	410-002	69%	5,1
C 10,0	U 12,0 X 12,0	1000 X 2000 X 1,5	410-002	69%	7,7
C 10,0	U 12,0 X 12,0	1000 X 2000 X 2,0	410-002	69%	10,3
C 10,0	U 15,0 X 15,0	1000 X 2000 X 3,0	410-005	44%	27,9
C 15,0	U 20,0 X 20,0	1000 X 2000 X 1,5	415-000	56%	11,0
C 15,0	U 20,0 X 20,0	1000 X 2000 X 2,0	415-000	56%	14,7
Clover 9,78	M 10,61	1000 X 2000 X 1,0	1-005	46%	8,8
R 6/9,75	U 15,0 X 15,0	1000 X 2000 X 1,0	1-006	36%	10,4
Clover 12,23	M 13,58	1000 X 2000 X 1,0	1-020	46%	8,8
Clover 12,23	M 13,58	1250 X 2500 X 1,0	1-020	46%	13,7
Clover 12,23	M 13,58	1000 X 2000 X 1,5	1-020	46%	13,2
Clover 12,23	M 13,58	1250 X 2500 X 1,5	1-020	46%	20,5
Clover 12,23	M 13,58	1000 X 2000 X 2,0	1-020	46%	17,6
Clover 12,23	M 13,58	1250 X 2500 X 2,0	1-020	46%	27,3
Clover 11,5	22,85 X 22,4	1000 X 2000 X 1,0	2-000	44%	9,3
Clover 11,5	22,85 X 22,4	1000 X 2000 X 1,5	2-000	44%	13,9
Braid 10,0	M 26,3	1000 X 2000 X 1,0	45-000	29%	11,7
34,5 X 48,0	55,0 X 55,0	1000 X 2000 X 1,0	46-000	38%	10,2
C 7,5	M 11,5 X 16	1000 X 2000 X 1,0	3407-008	43%	9,6
8,0 X 12,0	13,25 X 20,0	1000 X 2000 X 2,0	509-000	0%	32,0
R6,6/R3,8	U 20,0 X 20,0	1000 X 2000 X 2,0	737-011	21%	24,6
R7,3/R5,0	M 17,68	1000 X 2000 X 2,0	4209-000	20%	22,9
11,0/11,0	M 36,36	1000 X 2015 X 2,0	4210-000	14%	25,3

TERAS PILUAVAGA LAIUSE SUUNAS REAS

Ava mm	Samm mm	Laius x pikkus x paksus mm	Tüüm no	Avatud pind	Kaal kg / tk
LR 1,0 X 20,0	U 2,5 X 24,0	1000 X 2000 X 1,0	1105-000	33%	10,9
LR 1,5 X 20,0	U 3,0 X 24,0	1000 X 2000 X 1,0	1155-000	41%	9,6
LR 2,0 X 20,0	U 4,0 X 24,0	1000 X 2000 X 1,0	1205-000	41%	9,7
LR 2,5 X 20,0	U 5,0 X 24,0	1000 X 2000 X 1,0	1255-000	41%	9,4
LR 3,0 X 20,0	U 6,0 X 24,0	1000 X 2000 X 1,0	1305-000	40%	9,7
LR 4,0 X 20,0	U 8,0 X 24,0	1000 X 2000 X 1,5	1404-000	40%	9,4
LR 5,0 X 25,0	U 8,0 X 32,0	1000 X 2000 X 1,0	1506-000	47%	8,5
LR 6,0 X 25,0	U 10,0 X 32,0	1000 X 2000 X 1,0	1606-000	45%	8,8

TERAS PILUAVAGA PIKKUSE SUUNAS VAHELDUMISI

Ava mm	Samm mm	Laius x pikkus x paksus mm	Tüüm no	Avatud pind	Kaal kg / tk
LR 1,0 X 20,0	Z 6,32 X 24,0	1000 X 2000 X 1,0	1105-006	26%	12,0
LR 1,5 X 20,0	Z 7,5 X 24,0	1000 X 2000 X 1,0	1155-006	33%	10,7

R = ümar, C = nelinurk, LR = pilu, T = kolmjagu, U = nelijagu

409-012

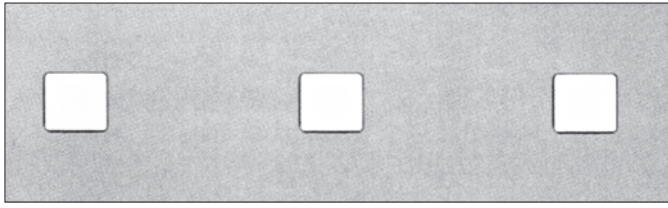

409-013

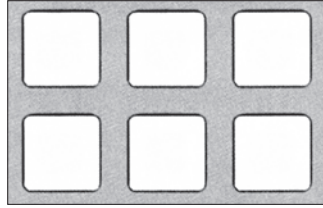

410-002

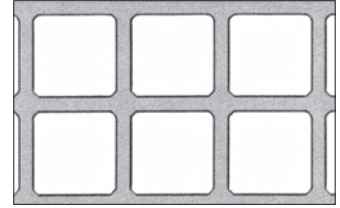

410-005

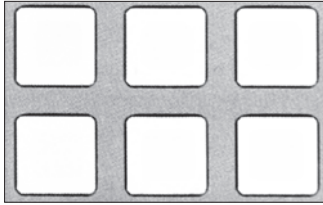

415-000

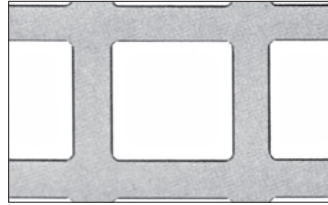

1-005

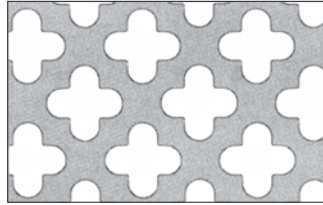

1-006

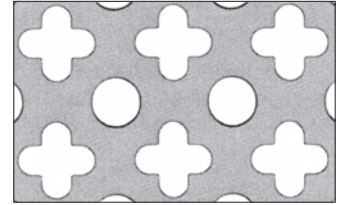

1-020

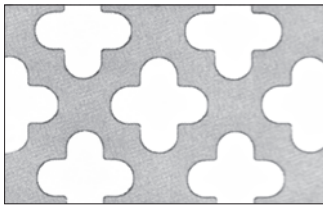

2-000



45-000

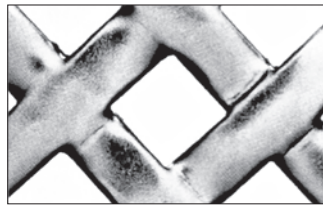

46-000

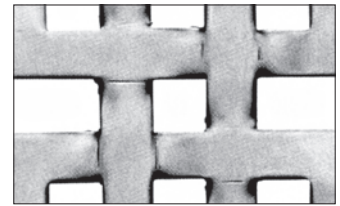

3407-008

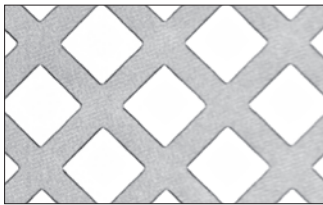

509-000

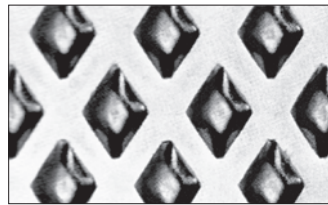

737-011

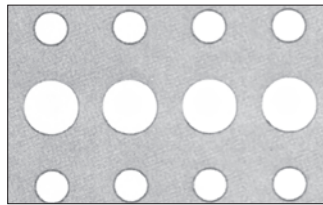

4209-000

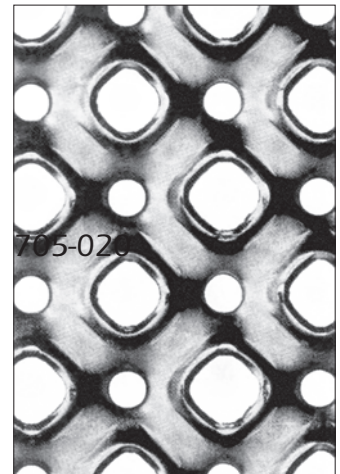

4210-000



1105-000



1155-000



705-020

1205-000



1255-000



1305-000



1404-000

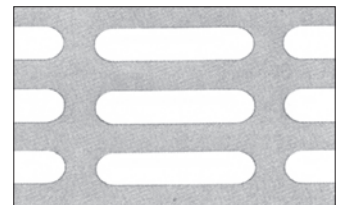

1506-000



1606-000

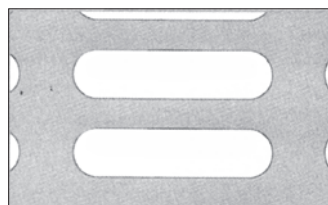

1105-006

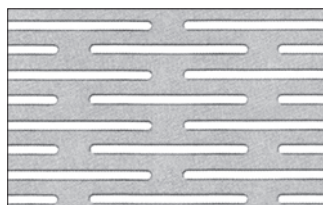

1155-006

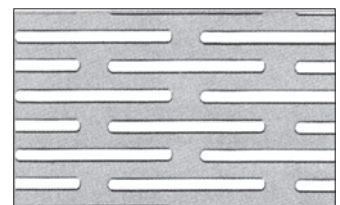

TERAS PILUAVAGA PIKKUSE SUUNAS VAHELDUMISI

Ava mm	Samm mm	Laius x pikkus x paksus mm	Tüüm no	Avatud pind	Kaal kg / tk
LR 2,0 X 20,0	Z 8,88 X 24,0	1000 X 2000 X 1,0	1205-006	37%	10,1
LR 2,5 X 20,0	Z 10,8 X 24,0	1000 X 2000 X 1,0	1255-006	38%	9,9
LR 3,0 X 20,0	Z 12,0 X 24,0	1000 X 2000 X 1,0	1305-006	40%	9,4
LR 3,0 X 20,0	Z 12,0 X 24,0	1000 X 2000 X 1,5	1305-006	40%	14,4
LR 3,5 X 20,0	Z 14,0 X 24,0	1000 X 2000 X 1,0	1355-006	40%	9,4
LR 4,0 X 20,0	Z 12,0 X 30,0	1000 X 2000 X 1,0	1606-006	43%	9,0

KUUMTSINGITUD TERAS ÜMARA JA NELIKANTAVAGA JA ERITÜÜBID

Ava mm	Samm mm	Laius x pikkus x paksus mm	Tüüm no	Avatud pind	Kaal kg / tk
R 2,0	T 3,5	1000 X 2000 X 0,7	720-000	30%	7,8
R 2,0	T 3,5	1000 X 2000 X 1,0	720-000	30%	11,3
R 3,0	T 5,0	1000 X 2000 X 0,6	730-000	33%	6,4
R 3,0	T 5,0	1000 X 2000 X 0,75	730-000	33%	8,2
R 3,0	T 5,0	1250 X 2500 X 0,75	730-000	33%	12,7
R 3,0	T 5,0	1000 X 2000 X 1,0	730-000	33%	10,9
R 3,0	T 5,0	1250 X 2500 X 1,0	730-000	33%	17,0
R 3,0	T 5,0	1500 X 3000 X 1,0	730-000	33%	24,1
R 3,0	T 5,0	1000 X 2000 X 1,5	730-000	33%	16,1
R 3,0	T 6,0	1000 X 2000 X 0,6	730-019	23%	7,4
R 3,0	T 6,0	1000 X 2000 X 1,0	730-019	23%	12,3
R 4,0	T 6,0	1000 X 2000 X 1,0	740-020	40%	9,6
R 5,0	T 6,5	1000 X 2000 X 0,7	750-021	56%	4,6
R 5,0	T 6,5	1000 X 2000 X 1,0	750-021	56%	6,6
R 5,0	T 7,5	1000 X 2000 X 0,6	750-000	40%	5,8
R 5,0	T 7,5	1000 X 2000 X 0,7	750-000	40%	6,7
R 5,0	T 7,5	1000 X 2000 X 1,0	750-000	40%	9,6
R 5,0	T 7,5	1000 X 2000 X 1,5	750-000	40%	14,5
R 5,0	T 8,0	1000 X 2000 X 1,0	750-002	35%	10,4
R 5,0	T 8,0	1250 X 2500 X 1,0	750-002	35%	16,2
R 5,0	T 8,0	1000 X 2000 X 2,0	750-002	35%	20,8
R 5,0	U 10,0 X 10,0	1000 X 2000 X 1,0	750-003	20%	12,8
R 5,0	U 14,0 X 14,0	1000 X 2000 X 1,0	750-078	10%	14,4
R 6,0	T 8,0	1000 X 2000 X 1,0	760-000	51%	8,1
R 6,0	T 8,0	1250 X 2500 X 1,0	760-000	51%	12,5
R 6,0	T 8,0	1250 X 2500 X 2,0	760-000	51%	25,1
R 10,0	U 26,0 X 26,0	1000 X 2000 X 1,0	810-022	12%	14,2
C 8,0	U 10,0 X 10,0	1000 X 2000 X 1,0	408-005	64%	5,8
C 8,0	U 10,0 X 10,0	1000 X 2000 X 1,5	408-005	64%	8,9
C 9,5	U 13,33 X 13,33	1000 X 2000 X 1,0	409-013	51%	8,1
C 9,5	U 13,33 X 13,33	1250 X 2500 X 1,0	409-013	51%	12,6
C 9,5	U 13,33 X 13,33	1000 X 2000 X 1,5	409-013	51%	12,1
C 10,0	U 12,0 X 12,0	1000 X 2000 X 1,0	410-002	69%	5,0
Clover 12,23	M 13,58	1000 X 2000 X 1,0	1-020	46%	8,9
R 7,31 R 5,0	M 17,68	1000 X 2000 X 1,0	4209-000	20%	22,9

R = ümar, C = nelinurk, LR = pilu, T = kolmjagu, U = nelijagu

1205-006

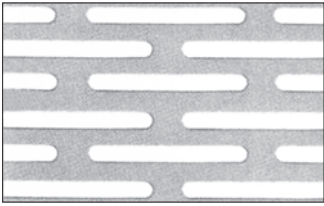

1255-006

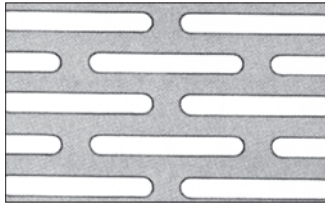

1305-006

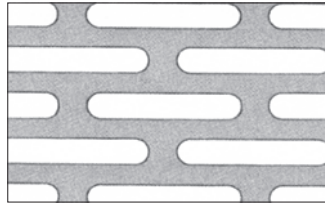

1355-006

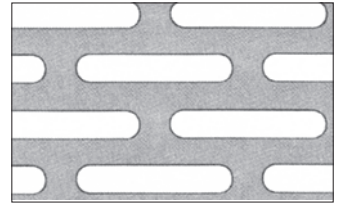

1404-006

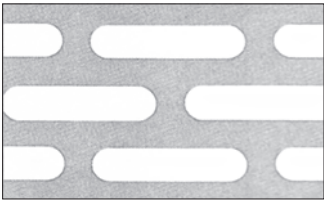

1606-006

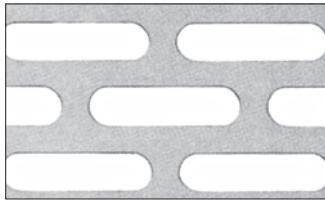

720-000

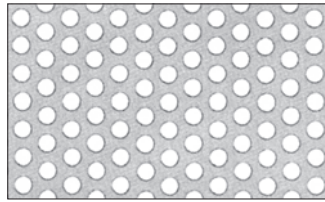

730-000

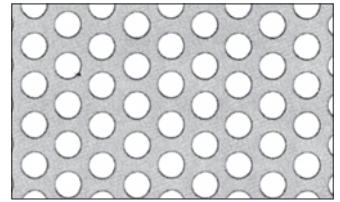

730-019

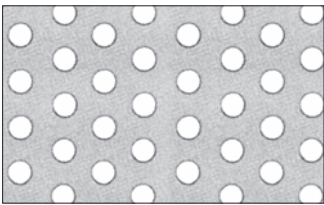

740-020

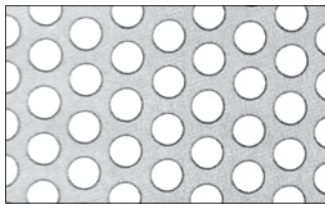

750-021

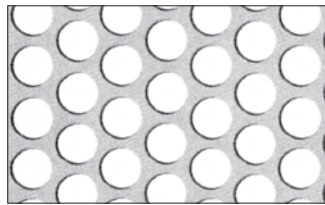

750-000

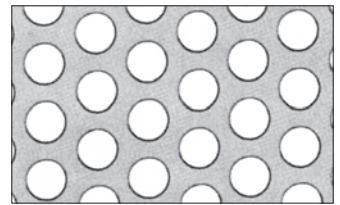

750-002

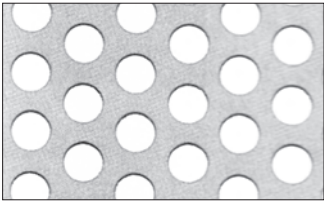

750-003

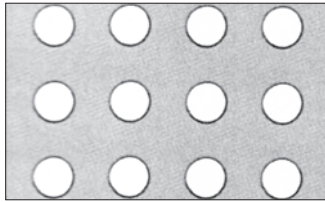

750-078

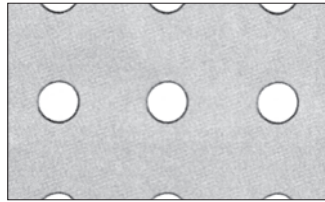

760-000

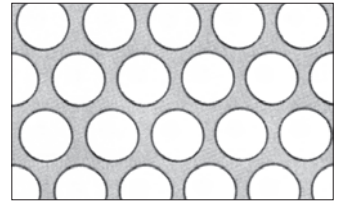

810-022

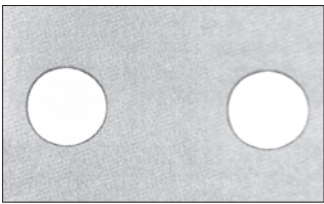

408-005

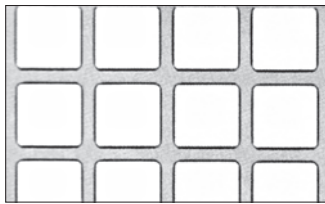

409-013

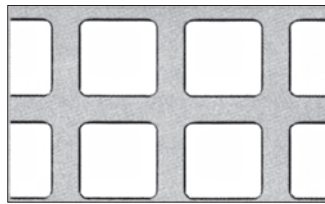

410-002

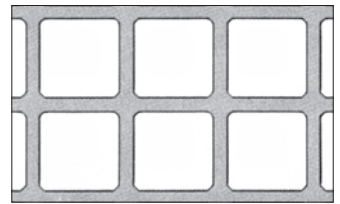

1-020

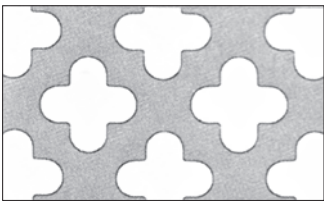

4209-000

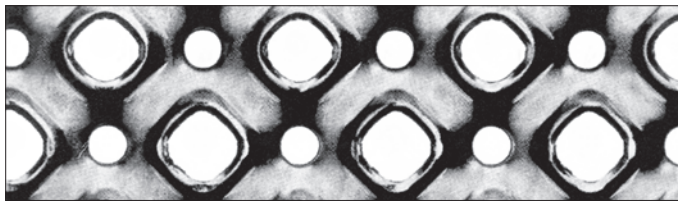

PÄRAST PERFOREERIMIST KUUMTSINGITUD TERAS NELIKANT AVAGA

Ava mm	Samm mm	Laius x pikkus x paksus mm	Tüüm no	Avatud pind	Kaal kg / tk
C 9,5	U 13,33 X 13,33	1000 X 2000 X 1,5	409-013	51%	13,1
C 9,5	U 13,33 X 13,33	1000 X 2000 X 2,0	409-013	51%	18,5

ALUMIINIUM EN 1050 A (2S) ÜMARA- JA NELIKANTAVAGA

Ava mm	Samm mm	Laius x pikkus x paksus mm	Tüüm no	Avatud pind	Kaal kg / tk
R 1,0	T 2,0	1000 X 2000 X 0,7	710-000	23%	3,8
R 1,5	T 2,6	1000 X 2000 X 1,0	715-000	30%	3,8
R 2,0	T 3,5	1000 X 2000 X 1,0	720-000	30%	3,8
R 2,0	T 3,5	1000 X 2000 X 1,5	720-000	30%	5,7
R 3,0	T 5,0	1000 X 2000 X 1,0	730-000	33%	3,7
R 3,0	T 5,0	1000 X 2000 X 1,5	730-000	33%	5,5
R 4,0	T 6,0	1000 X 2000 X 2,0	740-020	40%	6,5
R 5,0	T 7,5	1000 X 2000 X 1,0	750-000	40%	3,3
R 5,0	T 7,5	1000 X 2000 X 1,5	750-000	40%	4,9
R 5,0	T 7,5	1000 X 2000 X 2,0	750-000	40%	6,5
R 5,0	T 8,0	1250 X 2500 X 1,0	750-002	35%	5,5
R 8,0	T 11,0	1000 X 2000 X 2,0	780-020	48%	5,6
R 10,0	T 15,0	1000 X 2000 X 3,0	810-003	40%	9,7
R 15,0	T 21,0	1000 X 2000 X 3,0	815-000	46%	8,8
C 5,0	U 7,5 X 7,5	1000 X 2000 X 1,5	405-000	44%	4,6
C 9,5	U 13,3 X 13,3	1000 X 2000 X 1,0	409-013	51%	2,7
C 10,0	U 12,0 X 12,0	1000 X 2000 X 2,0	410-002	69%	3,4
C 10,0	U 14,0 X 14,0	1000 X 2000 X 1,0	410-000	51%	2,7
C 10,0	U 14,0 X 14,0	1000 X 2000 X 2,0	410-000	51%	5,3

ALUMIINIUM EN 5754 (ALMG3 - 57S) ÜMARA- JA PILUAVAGA MEREVEE KINDLAD

Ava mm	Samm mm	Laius x pikkus x paksus mm	Tüüm no	Avatud pind	Kaal kg / tk
R 1,5	T 2,6	1000 X 2000 X 1,0	715-000	30%	3,8
R 2,0	T 3,5	1000 X 2000 X 1,0	720-000	30%	3,8
R 3,0	T 5,0	1000 X 2000 X 1,0	730-000	33%	3,7
LR 2,0 X 20,0	U 4,0 X 24,0	1000 X 2000 X 1,0	1205-000	41%	3,2
LR 3,0 X 20,0	U 6,0 X 24,0	1000 X 2000 X 1,0	1305-000	40%	3,2

ROOSTEVABA TERAS 1.4301 (AISI 304) PERFOCON-AUGUSTUS

Ava mm	Samm mm	Laius x pikkus x paksus mm	Tüüm no	Avatud pind	Kaal kg / tk
0,2	2,5 X 1,6	669 X 2500 X 0,6	512508-020	3%	7,8

ROOSTEVABA TERAS EN 1.4301 (AISI 304) ÜMARA AVAGA

Ava mm	Samm mm	Laius x pikkus x paksus mm	Tüüm no	Avatud pind	Kaal kg / tk
R 0,5	T 1,09	1000 X 2000 X 0,4	705-020	19%	5,2
R 0,5	T 1,09	1000 X 2000 X 0,5	705-020	19%	6,5
R 0,6	T 1,4	1000 X 2000 X 0,5	706-000	17%	6,8
R 0,55 + 0,05	T 1,4	1000 X 2000 X 0,5	706-040	10%	6,7

R = ümar, C = nelinurk, LR = pilu, T = kolmjagu, U = nelijagu

409-013

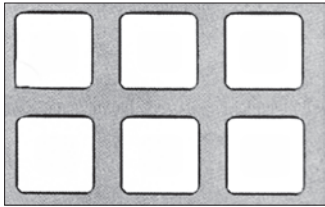

710-000

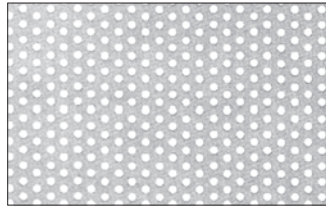

715-000

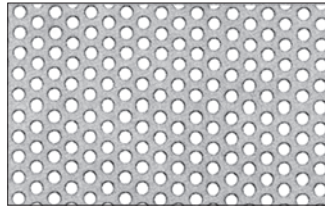

720-000

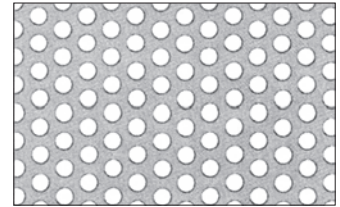

730-000

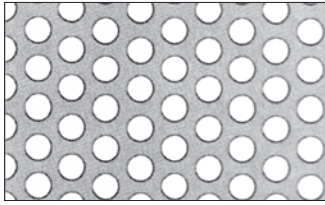

740-020

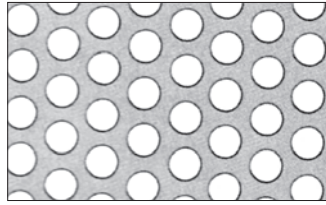

750-000

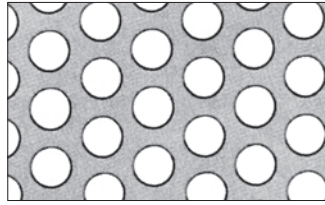

750-002

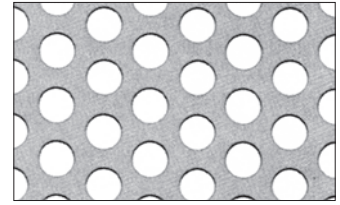

780-020

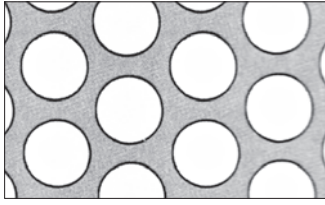

810-003

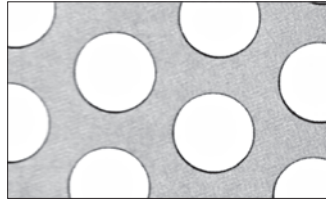

815-000

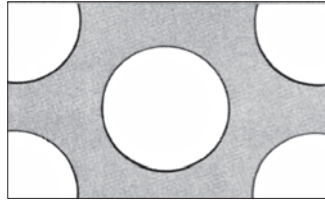

405-000

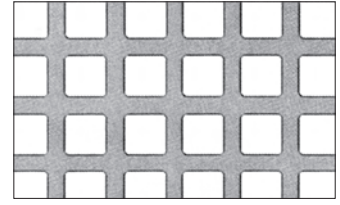

409-013

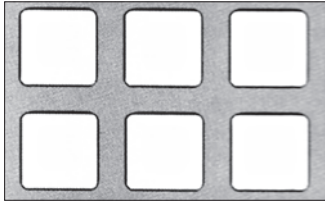

410-002

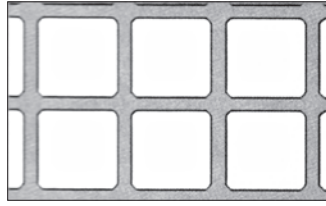

410-000

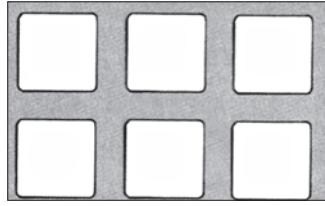

715-000

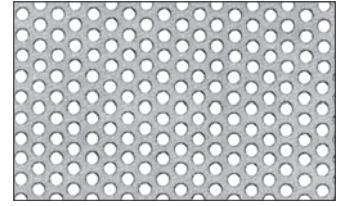

720-000

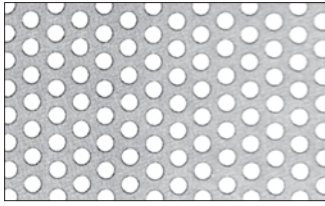

730-000

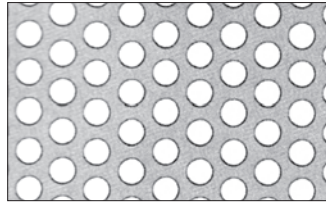

1205-000

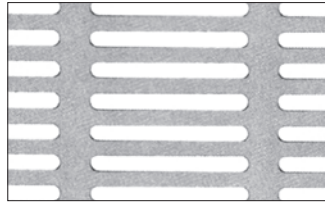

1305-000

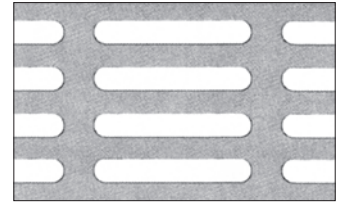

512508-020

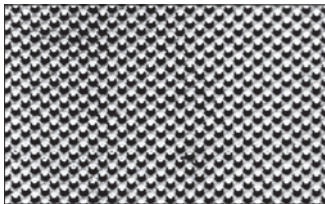

705-020

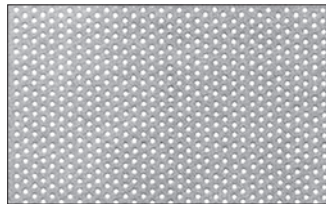

706-000



706-040

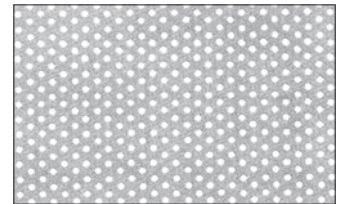

ROOSTEVABA TERAS EN 1.4301 (AISI 304) ÜMARA AVAGA

Ava mm	Samm mm	Laius x pikkus x paksus mm	Tüüm no	Avatud pind	Kaal kg / tk
R 0,75	T 1,5	1000 X 2000 X 0,6	707-001	M	7,5
R 1,0	T 2,0	1000 X 2000 X 0,7	710-000	23%	8,7
R 1,0	T 2,0	1000 X 2000 X 1,0	710-000	23%	12,4
R 1,25	T 2,4	1000 X 2000 X 1,0	712-008	25%	12,1
R 1,5	T 2,6	1000 X 2000 X 1,0	715-000	30%	11,2
R 1,5	T 3,0	1000 X 2000 X 1,5	715-001	23%	18,9
R 2,0	T 3,0	1000 X 2000 X 1,0	720-002	40%	9,6
R 2,0	T 3,5	1000 X 2000 X 1,0	720-000	30%	11,3
R 2,0	T 3,5	1000 X 2000 X 1,5	720-000	30%	17,0
R 2,0	T 4,0	1000 X 2000 X 2,0	720-001	23%	25,1
R 2,5	T 4,5	1000 X 2000 X 1,5	725-000	28%	17,2
R 3,0	T 5,0	1000 X 2000 X 0,7	730-000	33%	7,3
R 3,0	T 5,0	1000 X 2000 X 1,0	730-000	33%	10,9
R 3,0	T 5,0	1250 X 2500 X 1,0	730-000	33%	17,0
R 3,0	T 5,0	1000 X 2000 X 1,5	730-000	33%	16,3
R 3,0	T 5,0	1250 X 2500 X 1,5	730-000	33%	25,4
R 3,0	T 5,0	1000 X 2000 X 3,0	730-000	33%	33,2
R 4,0	T 5,6	1000 X 2000 X 1,0	740-000	46%	8,7
R 4,0	T 5,6	1000 X 2000 X 2,0	740-000	46%	17,3
R 4,0	T 6,0	1000 X 2000 X 1,5	740-020	40%	14,5
R 5,0	T 7,5	1000 X 2000 X 1,0	750-000	40%	9,6
R 5,0	T 7,5	1000 X 2000 X 1,5	750-000	40%	14,5
R 5,0	T 8,0	1000 X 2000 X 1,0	750-002	35%	10,4
R 5,0	T 8,0	1000 X 2000 X 2,0	750-002	35%	20,8
R 5,0	T 8,0	1000 X 2000 X 3,0	750-002	35%	31,2
R 5,0	T 8,0	1000 X 2000 X 5,0	750-002	35%	52,0
R 6,0	T 8,0	1000 X 2000 X 1,0	760-000	51%	8,0
R 6,0	T 8,0	1000 X 2000 X 1,5	760-000	51%	12,1
R 6,0	T 9,0	1500 X 3000 X 1,5	760-020	40%	32,0
R 8,0	T 10,0	1000 X 2000 X 1,0	780-000	58%	6,9
R 8,0	T 10,0	1000 X 2000 X 1,5	780-000	58%	10,4
R 8,0	T 11,0	1000 X 2000 X 2,0	780-020	48%	17,1
R 8,0	T 11,0	1000 X 2000 X 3,0	780-020	48%	25,0
R 8,0	T 15,0	1000 X 2000 X 8,0	780-028	26%	94,7
R 10,0	T 12,7	1000 X 2000 X 1,0	810-000	56%	7,0
R 10,0	T 12,7	1000 X 2000 X 1,5	810-000	56%	10,7
R 10,0	T 12,7	1000 X 2000 X 2,0	810-000	56%	14,3
R 10,0	T 14,0	1000 X 2000 X 1,0	810-044	46%	8,6
R 10,0	T 15,0	1000 X 2000 X 1,5	810-003	40%	14,6
R 10,0	T 15,0	1000 X 2000 X 3,0	810-003	40%	28,8
R 10,0	T 15,0	1000 X 2000 X 4,0	810-003	40%	38,4
R 12,0	T 16,0	1000 X 2000 X 2,0	812-000	51%	15,7

ROOSTEVABA TERAS EN 1.4301 (AISI 304) NELIKANT- JA PILUAVAGA

Ava mm	Samm mm	Laius x pikkus x paksus mm	Tüüm no	Avatud pind	Kaal kg / tk
C 5,0	U 7,5 X 7,5	1000 X 2000 X 1,0	405-000	44%	9,0
C 8,0	U 10,0 X 10,0	1000 X 2000 X 1,0	408-005	64%	5,7
C 9,5	U 13,33 X 13,33	1000 X 2000 X 1,0	409-013	51%	8,1
C 9,5	U 13,33 X 13,33	1000 X 2000 X 2,0	409-013	51%	16,2

R = ümar, C = nelinurk, LR = pilu, T = kolmjagu, U = nelijagu

707-001



710-000

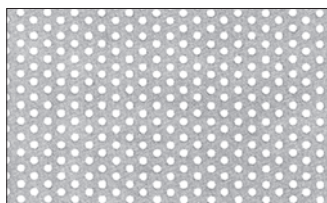

712-008

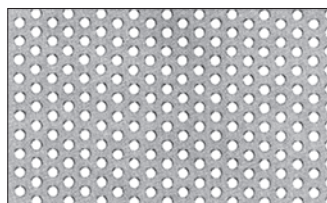

715-000

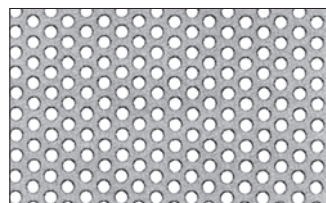

715-001

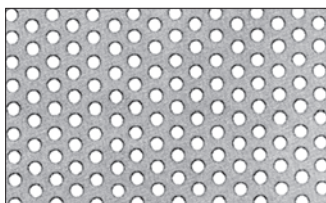

720-002

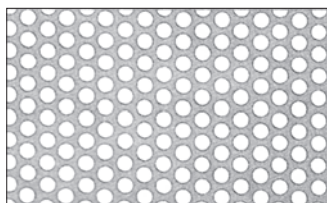

720-000

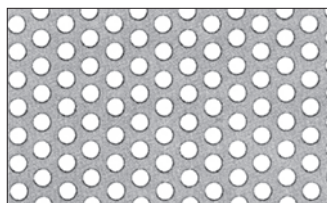

720-001

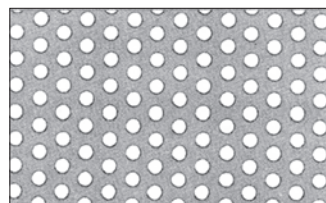

725-000

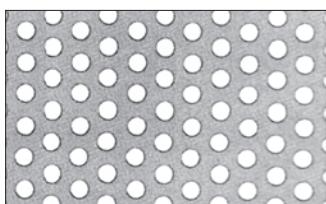

730-000

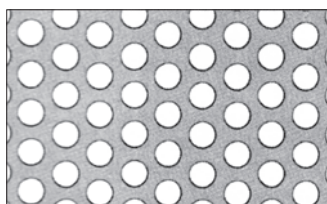

740-000

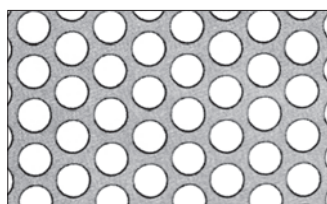

740-020

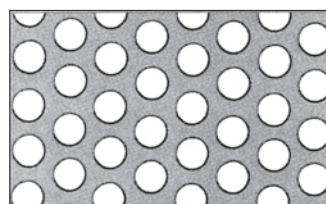

750-000

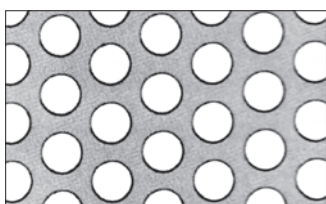

750-002

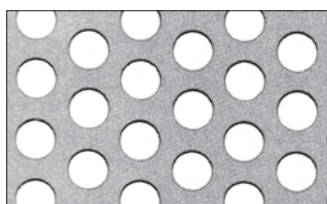

760-000

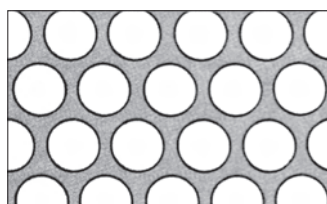

760-020

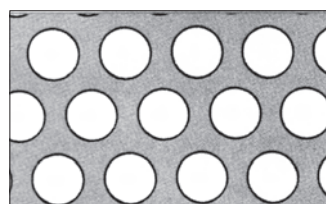

780-000

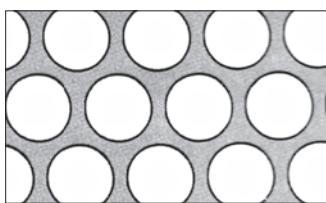

780-020

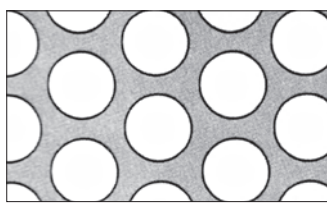

780-028

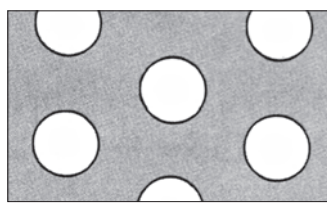

810-000

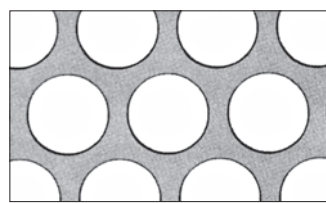

810-044

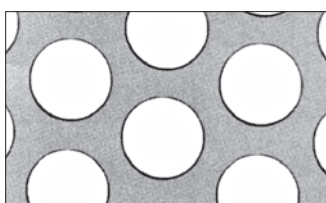

810-003

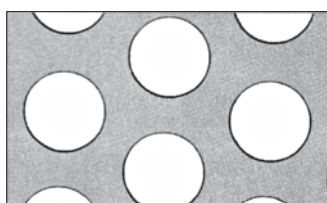

812-000

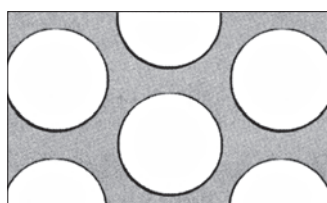

405-000

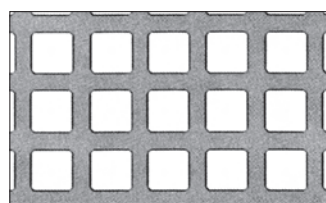

408-005

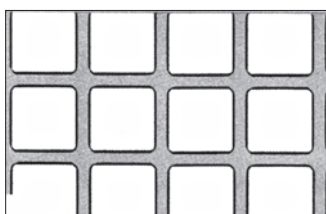

409-013

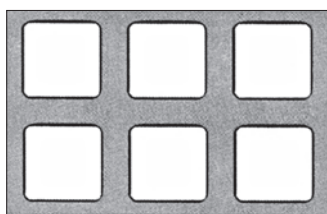

ROOSTEVABA TERAS EN 1.4301 (AISI 304) NELIKANT- JA PILUAVAGA

Ava mm	Samm mm	Laius x pikkus x paksus mm	Tüüm no	Avatud pind	Kaal kg / tk
C 9,5	U 13,33 X 13,33	1000 X 2000 X 3,0	409-013	51%	25,1
C 10,0	U 12,0 X 12,0	1000 X 2000 X 1,0	410-002	69%	5,1
C 10,0	U 14,0 X 14,0	1000 X 2000 X 1,0	410-000	51%	7,8
C 10,0	U 14,0 X 14,0	1000 X 2000 X 1,5	410-000	51%	11,8
LC 0,35 X 4,0	Z 2,68 X 5,0	1000 X 2000 X 0,5	1035-007	21%	6,4
LC 0,37 X 4,0	U 1,17 X 5,65	1000 X 2000 X 0,5	1037-001	22%	6,2
LR 1,0 X 10,0	Z 7,0 X 14,0	1000 X 2000 X 1,0	1101-006	20%	13,0
LR 2,0 X 20,0	U 4,0 X 24,0	1000 X 2000 X 1,0	1205-000	41%	9,4
LR 3,0 X 20,0	U 6,0 X 24,0	1000 X 2000 X 1,5	1305-000	40%	14,4
LR 5,0 X 25,0	U 8,0 X 32,0	1000 X 2000 X 1,5	1506-000	47%	12,7
R 7,31 R 5,0	M 17,68	1000 X 2000 X 1,5	4209-000	20%	16,7

HAPPEKINDEL TERAS EN 1.4401 (AISI 316) ÜMARA-, NELIKANT- JA PILUAVAGA

Ava mm	Samm mm	Laius x pikkus x paksus mm	Tüüm no	Avatud pind	Kaal kg / tk
R 1,0	T 2,0	1000 X 2000 X 1,0	710-000	23%	12,4
R 2,0	T 3,5	1000 X 2000 X 1,0	720-000	30%	11,3
R 3,0	T 5,0	1000 X 2000 X 1,0	730-000	33%	10,9
R 3,0	T 5,0	1250 X 2500 X 1,0	730-000	33%	17,0
R 3,0	T 5,0	1000 X 2000 X 1,5	730-000	33%	16,1
R 3,0	T 5,0	1000 X 2000 X 2,0	730-000	33%	21,4
R 5,0	T 7,5	1250 X 2500 X 1,0	750-000	40%	15,0
R 5,0	T 8,0	1000 X 2000 X 1,0	750-002	35%	10,4
R 5,0	T 8,0	1000 X 2000 X 1,5	750-002	35%	15,6
R 6,0	T 9,0	1000 X 2000 X 2,0	760-020	40%	19,5
R 8,0	T 10,0	1000 X 2000 X 1,5	780-000	58%	10,4
R 10,0	T 15,0	1000 X 2000 X 3,0	810-003	40%	29,7
C 9,5	U 13,33 X 13,33	1000 X 2000 X 1,0	409-013	51%	7,8
LR 2,0 X 20,0	Z 8,88 X 24,0	1000 X 2000 X 1,5	1205-006	37%	15,2
LR 4,0 X 20,0	U 8,0 X 24,0	1000 X 2000 X 1,0	1404-000	40%	9,6

R = ümar, C = nelinurk, LR = pilu, T = kolmjagu, U = nelijagu

409-013

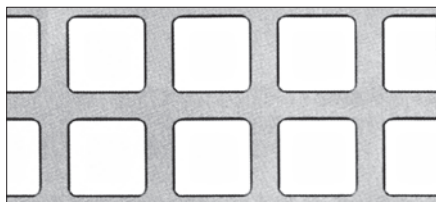

410-002

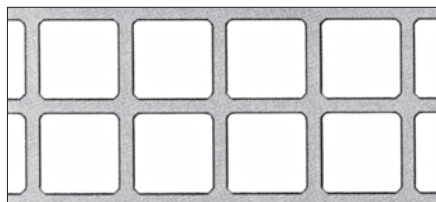

410-000

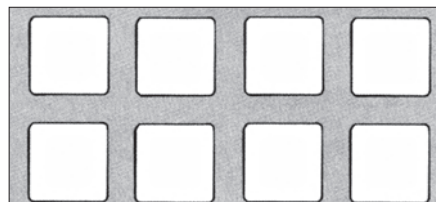

1035-007

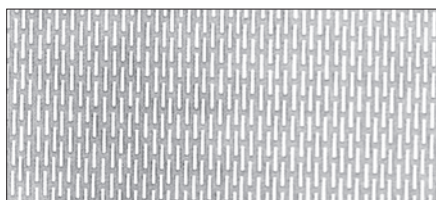

1037-001

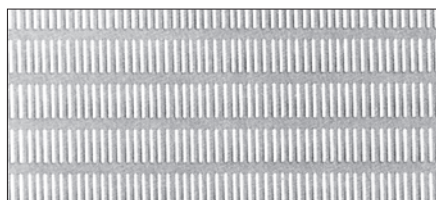

1101-006

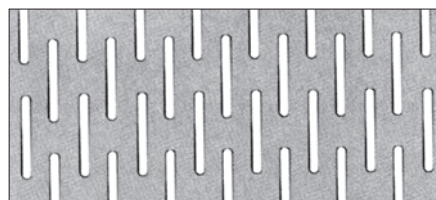

1205-000



1305-000



1506-000



4209-000



710-000

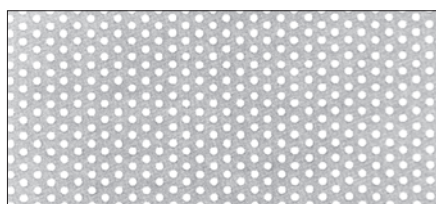

720-000

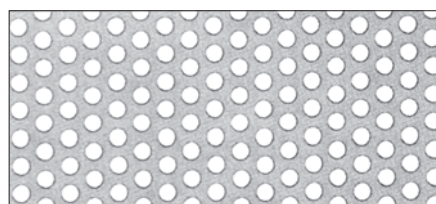

730-000

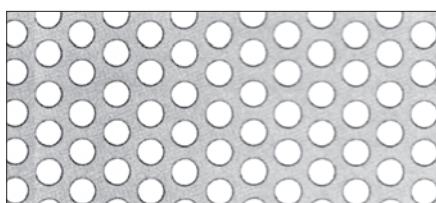

750-000

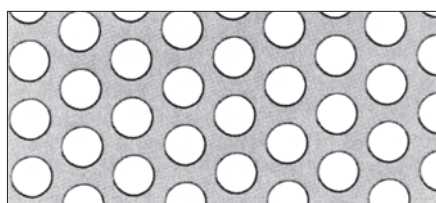

750-002

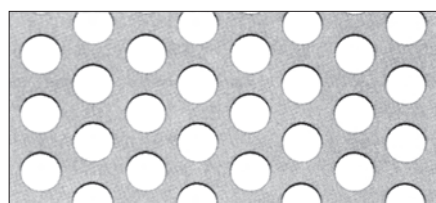

760-020

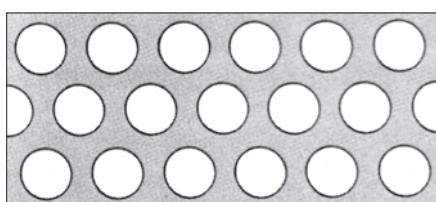

780-000

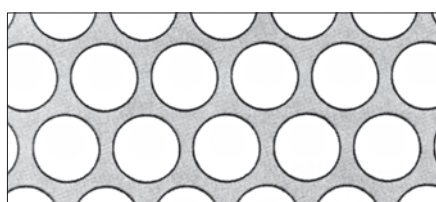

810-003

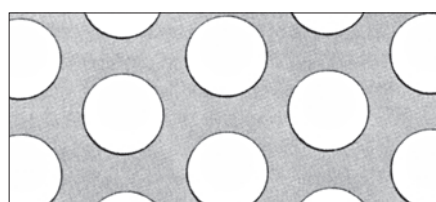

490-013

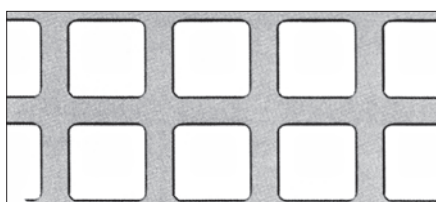

1205-006



1404-000



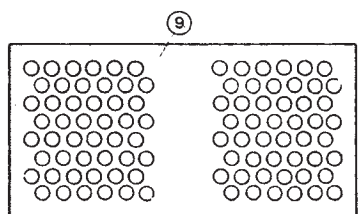
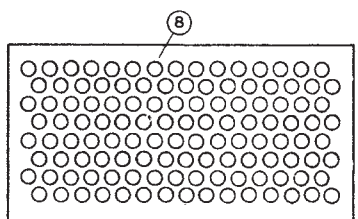
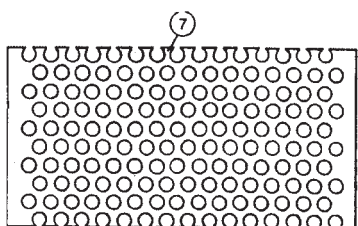
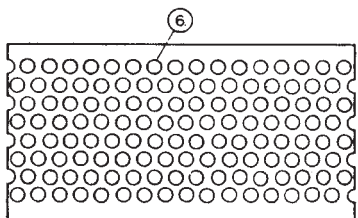
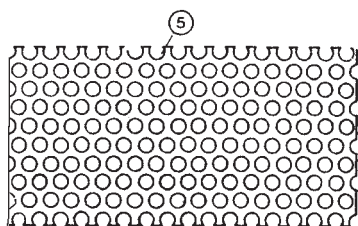
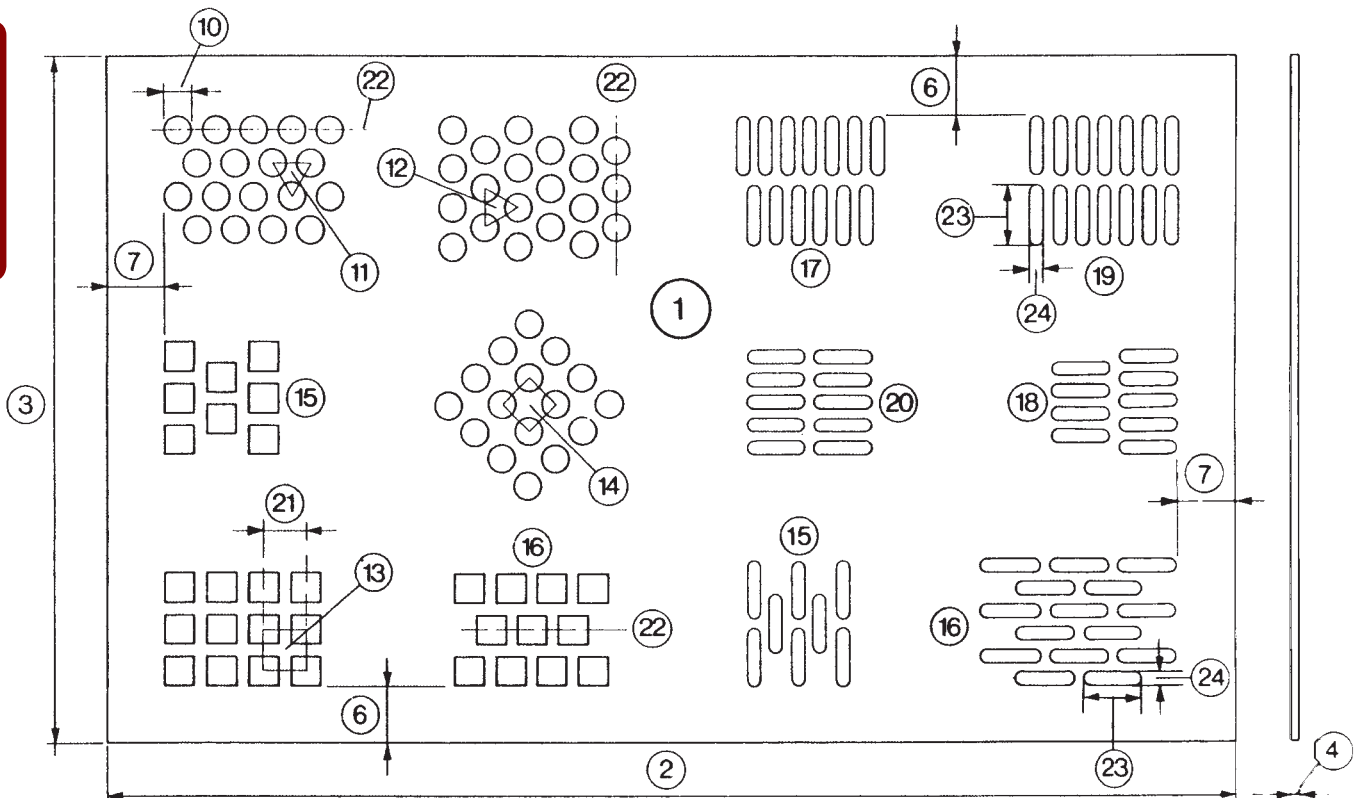

1. Perforeeritud leht
2. Pikkus
3. Laius
4. Paksus
5. Perforatsioon ääreni
6. Perforeerimata pikem äär
7. Perforeerimata lühem äär
8. Perforeerimata kõik ääred
9. Perforeering kohati
10. Ava läbimõõt
11. Kolmikjagu pikkuse suunas
12. Kolmikjagu laiuse suunas
13. Nelikjagu
14. Nelikjagu diagonaalis
15. Astmeline avarivi laiuse suunas
16. Astmeline avarivi pikkuse suunas
17. Avade otsad astmes pikkuse suunas
18. Avade otsad astmes laiuse suunas
19. Avad ravis laiuse suunas
20. Avad ravis pikkuse suunas
21. Samm
22. Avade rivi
23. Ava pikkus
24. Ava laius

STÉN & Co OÜ

Silikaltsiidi 7
11216 Tallinn
www.sten.ee
info@sten.ee
+372 655 0641

Müük:
Reijo Aasrand
+372 512 3195
reijo.aasrand@sten.ee

Rauni Jeblakov
+372 524 6554
rauni.jeblakov@sten.ee

Rauno Kivisaar
+372 5657 1000
rauno.kivisaar@sten.ee